



3 bed terraced house to buy in

Ryal Walk, Newcastle upon Tyne, Tyne and Wear, NE3 3YE

£90,000 Starting Bid

 x3  x1  x1

Tenure

Freehold

Property features

- ✓ EPC TBC
- ✓ Central Location
- ✓ No Onward Chain
- ✓ Council Tax Band A

On Street parking

Key Information

- ✓ Council Tax: Band A
- ✓ Heating supply: Gas

Arrange a viewing

Maurice Porteous
Branch Manager
Gosforth

0191 2303365
gosforth@pattinson.co.uk

- ✓ Flexible viewing slots
- ✓ Accompanied viewings

Description

For sale via auction - fees apply.

Pattinson Gosforth are please to present this charming 3-bedroom terraced house nestled in the heart of Kenton, Newcastle upon Tyne. This home offers a central location, with the added convenience of no onward chain, making it an ideal property for both first-time buyers and investors alike.

Graced with timeless appeal, the property consists of: Entrance Hallway, modern kitchen, with an abundance of wall and floor units, downstairs WC for added convenience, an additional downstairs bedroom and sizeable lounge/diner completes the ground floor. To the first floor you will find two double bedrooms (with the option of converting to three bedrooms, ample cupboard space and storage along with a modern bathroom suite.

The outside of the property has a patio area to the front and enclosed rear garden, mostly laid to lawn to the rear of the property.

Additional benefits include Energy Performance Certificate (EPC) to be confirmed, and a council tax band of A

Its central location serves as a prime advantage, placing residents at the doorstep of Newcastle's vibrant city life, rich with its assortment of shopping, dining, leisure and entertainment options. With the city at your fingertips, this property keeps you connected while offering a cosy retreat from the hustle and bustle.

Boasting no onward chain, this property is ready to welcome its new owners with open arms. Don't miss this exceptional opportunity to secure a piece of Newcastle's ever popular residential scene.

Council Tax Band: A

Tenure: Freehold

Price: Starting Bid £90,000

Property Type: Terraced House

Parking: On Street

Heating: Gas

Approx Gross Internal Area
89 sq m / 959 sq ft

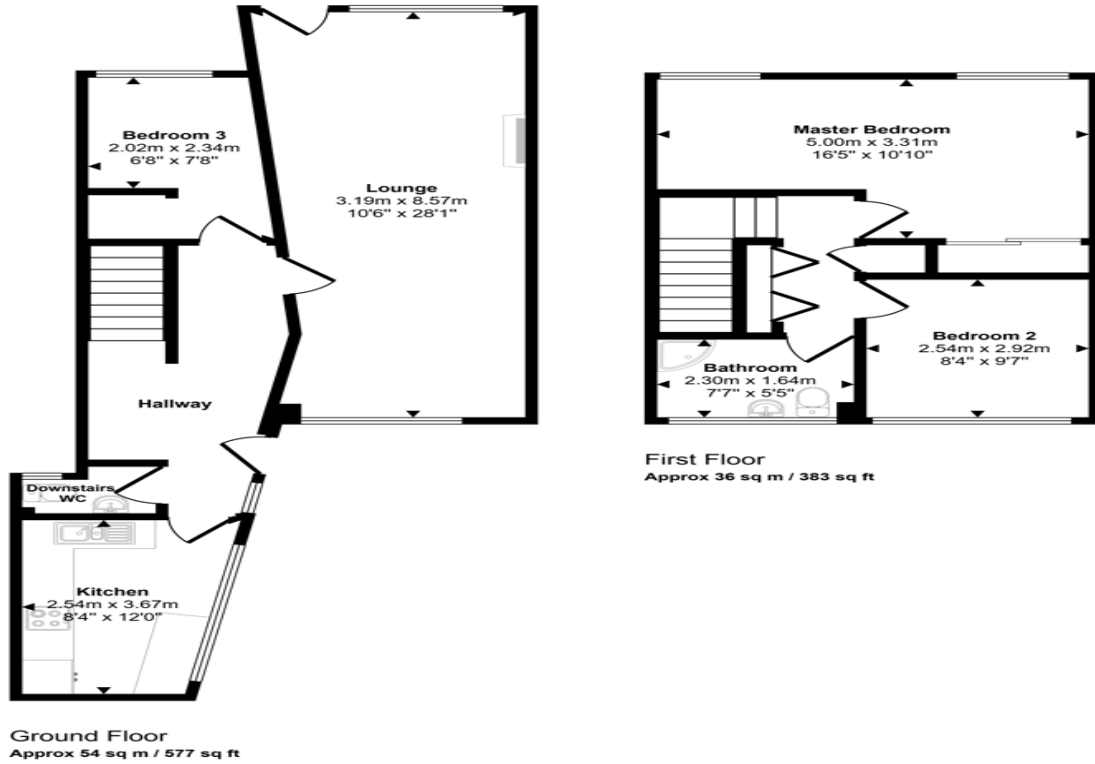

This floorplan is only for illustrative purposes and is not to scale. Measurements of rooms, doors, windows, and any items are approximate and no responsibility is taken for any error, omission or mis-statement. Icons of items such as bathroom suites are representations only and may not look like the real items. Made with Made Snappy 360.

Ryal Walk, Newcastle upon Tyne, Tyne and Wear, NE3 3YE

Contact your local branch today for more information on this property:

**210 High Street, Gosforth, Newcastle Upon Tyne, Tyne & Wear, NE3 1HH, Tel: 0191 2303365,
gosforth@pattinson.co.uk, www.pattinson.co.uk**

These particulars, whilst believed to be accurate are set out as a general outline only for guidance and do not constitute any part of an offer or contract. Intending purchasers should not rely on them as statements of representation of fact, but must satisfy themselves by inspection or otherwise as to their accuracy. No person in this firm's employment has the authority to make or give any representation or warranty in respect of the property.

