



2 bed bungalow to buy in NE23

Chichester Avenue, Nelson Village,
Cramlington, Northumberland, NE23 1HD

£159,950

🛏 x2 🚿 x1 🚻 x1

Tenure

Freehold

On Street parking

Property features

- ✓ Beautifully presented
- ✓ Two bedrooms
- ✓ Low maintenance rear garden
- ✓ EPC Rating D

Key Information

- ✓ Council Tax: Band A
- ✓ EPC Rating: D
- ✓ Heating supply: Gas

Arrange a viewing

Teri Dunning
Cramlington

01670 568098
cramlington@pattinson.co.uk

- ✓ Flexible viewing slots
- ✓ Accompanied viewings

Description

A well presented and spacious two bedroom bungalow situated in the popular residential area of Nelson Village, Cramlington, conveniently located close to local shops, amenities, and excellent transport links.

The accommodation comprises of a bright and comfortable lounge, two generously sized double bedrooms, a fitted kitchen/diner offering ample space for dining and entertaining, and a family bathroom.

Externally, the property benefits from a low maintenance rear yard, ideal for outdoor seating and easy upkeep.

Additional features include new carpets fitted throughout and a high standard of maintenance, making this an excellent opportunity for those seeking a home ready to move into.

Council Tax Band: A

Tenure: Freehold

Price: £159,950

Property Type: Bungalow

Parking: On Street

Heating: Gas

Living Room



Bedroom 1



Bathroom



Kitchen



Bedroom 2



Approx Gross Internal Area
78 sq m / 844 sq ft

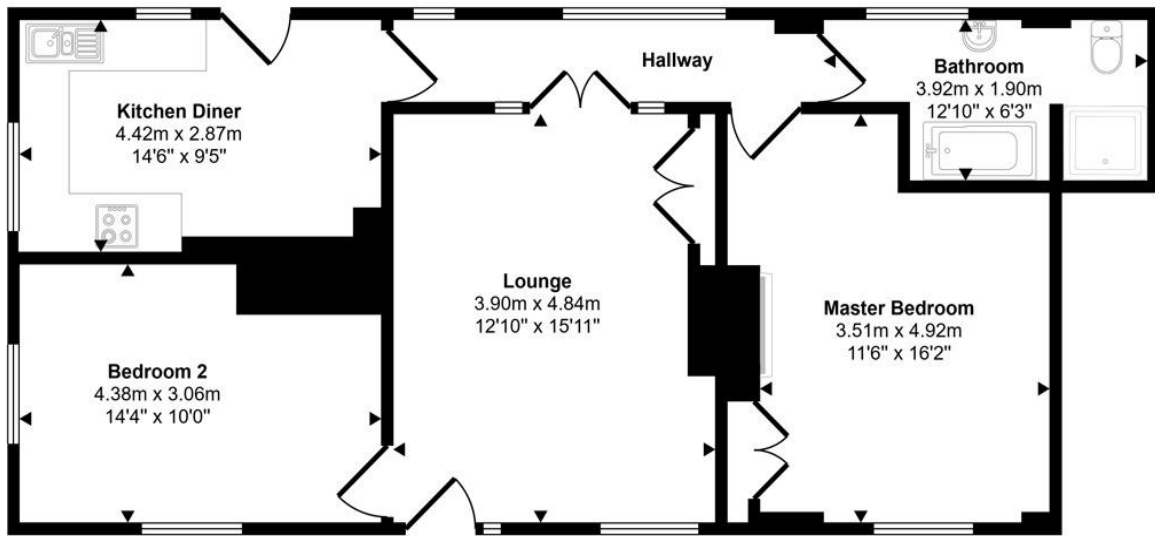

Floorplan

This floorplan is only for illustrative purposes and is not to scale. Measurements of rooms, doors, windows, and any items are approximate and no responsibility is taken for any error, omission or mis-statement. Icons of items such as bathroom suites are representations only and may not look like the real items. Made with Made Snappy 360.

Energy Efficiency Rating		
	Current	Potential
<i>Very energy efficient - lower running costs</i>		
(92-100) A		
(81-91) B		86
(69-80) C		
(55-68) D	63	
(39-54) E		
(21-38) F		
(1-20) G		
<i>Not energy efficient - higher running costs</i>		
England, Scotland & Wales		EU Directive 2002/91/EC

Chichester Avenue, Nelson Village, Cramlington, Northumberland, NE23 1HD

Contact your local branch today for more information on this property:

**Blagdon House Smithy Square, Cramlington, Northumberland, NE23 6QL, Tel: 01670 568098,
cramlington@pattinson.co.uk, www.pattinson.co.uk**

These particulars, whilst believed to be accurate are set out as a general outline only for guidance and do not constitute any part of an offer or contract. Intending purchasers should not rely on them as statements of representation of fact, but must satisfy themselves by inspection or otherwise as to their accuracy. No person in this firm's employment has the authority to make or give any representation or warranty in respect of the property.

