



2 bed apartment to buy in NE46

Kings Mews, Hexham, Northumberland,
NE46 1BG

£115,000 Starting Bid

🏠 x2 🚗 x2 🚻 x1

Tenure

Share Of Freehold

Garage parking

Property features

- ✓ Two Bedroom Apartment
- ✓ Share of Freehold
- ✓ Garage on site
- ✓ First Floor Apartment
- ✓ EPC Rating C

Key Information

- ✓ Council Tax: Band C
- ✓ EPC Rating: C
- ✓ Heating supply: Gas
- ✓ Electric supply: National Grid
- ✓ Water supply: Direct mains water
- ✓ Broadband: FTTC (fibre to the cabinet)
- ✓ Mobile signal: Good

Arrange a viewing

Lucy Sage
Branch Manager
Hexham

01434 605376
hexham@pattinson.co.uk

- ✓ Flexible viewing slots
- ✓ Accompanied viewings

Description

*** TWO BEDROOM APARTMENT***

SHARE OF FREEHOLD

GARAGE EN-BLOC

Pattinson are pleased to welcome to the market this two bedroom apartment, located on Eastgate in Hexham.

The property is entered via a secure entry door, with intercom system, and comprises an entrance hallway, with doors leading to the open plan living room/kitchen, both bedrooms, and the main bathroom. Bedroom 1 also features an en-suite. Externally, the property comes with a storage cupboard, a garage to the rear of the building, visitor parking, and a communal area located above the garage block.

Kings Mews is a small complex of flats and houses standing on Eastgate, just a short distance from the Town Centre, and situated in a popular residential location. Hexham is well served with shops, schools, leisure facilities, health centres and a hospital. It lies just off the A69 main trunk road and has a mainline rail station and regular bus routes to all points between Carlisle and Newcastle.

Early viewing is recommended, and you can arrange a viewing by contacting our Hexham Team.

Council Tax Band: C

Tenure: Share Of Freehold

Annual Service Charge Amount: £1,531.00

Price: Starting Bid £115,000

Property Type: Apartment

Parking: Garage

Construction materials: Brick and block

Heating: Gas

Electric: National Grid

Water: Direct mains water

Water meter: Yes

Sewerage: Standard UK domestic

Air conditioning: No

Broadband: FTTC (fibre to the cabinet)

Mobile signal coverage: Good

Entrance Hallway

Doors leading to living room/kitchen, both bedrooms and the bathroom.



Living Room

Open plan with the kitchen. Featuring French doors with a Juliette Balcony overlooking mature trees, and grassland.



Kitchen

Range of wall and floor units, central island housing more storage, the electric hob and oven, and integrated fridge/freezer. Double glazed sash window.



Bedroom 1

Dual aspect double glazed sash windows, featuring secondary glazing, double room, with in-built storage cupboard, and en-suite.



En-Suite

Large walk in shower, Toilet and Basin



Bedroom 2

Double room with alcove for storage, single aspect double glazed sash window, with secondary glazing and central heating radiator.



Bathroom

Featuring a white 3-piece suite, including low lying toilet, pedestal sink and bath with shower over. Central heating radiator and electric extractor fan.



Externally

The property benefits from an external, secure storage cupboard and a garage located to the rear of the building on the complex grounds.



Information

The property is located within Northumberland County Council area. It is being sold with a Share of the Freehold. It is Council Tax Band C.



Approx Gross Internal Area
48 sq m / 512 sq ft

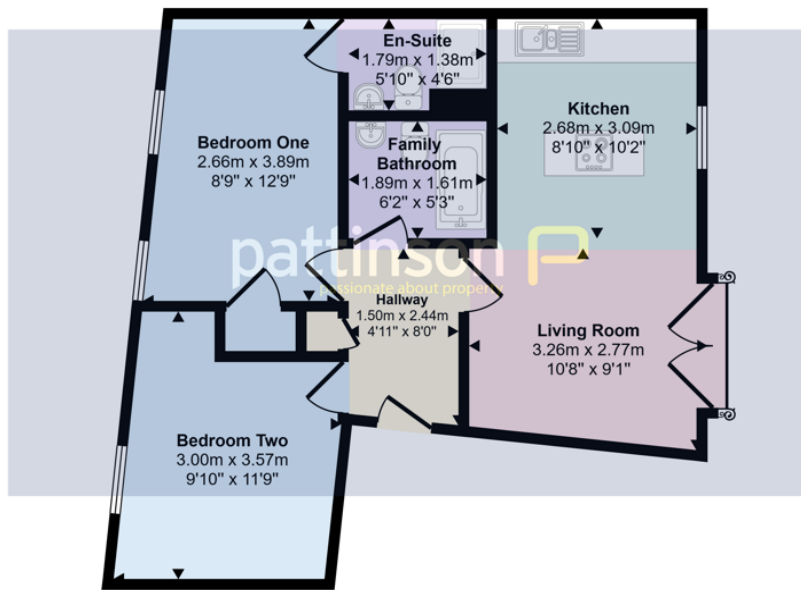

Floorplan

This floorplan is only for illustrative purposes and is not to scale. Measurements of rooms, doors, windows, and any items are approximate and no responsibility is taken for any error, omission or mis-statement. Icons of items such as bathroom suites are representations only and may not look like the real items. Made with Made Snappy 360.

Energy Efficiency Rating		
	Current	Potential
<i>Very energy efficient - lower running costs</i>		
(92-100) A		
(81-91) B		
(69-80) C	78	79
(55-68) D		
(39-54) E		
(21-38) F		
(1-20) G		
<i>Not energy efficient - higher running costs</i>		
England, Scotland & Wales	EU Directive 2002/91/EC	

Kings Mews, Hexham, Northumberland, NE46 1BG

Contact your local branch today for more information on this property:

**15 Priestpopple, Hexham, Northumberland, Tyne & Wear, NE46 1PH, Tel: 01434 605376,
hexham@pattinson.co.uk, www.pattinson.co.uk**

These particulars, whilst believed to be accurate are set out as a general outline only for guidance and do not constitute any part of an offer or contract. Intending purchasers should not rely on them as statements of representation of fact, but must satisfy themselves by inspection or otherwise as to their accuracy. No person in this firm's employment has the authority to make or give any representation or warranty in respect of the property.

