



2 bed apartment to buy in TS12

Marine Parade, Saltburn,
Saltburn-by-the-Sea, North Yorkshire,
TS12 1BZ

£145,000 Starting Bid

 x2  x1  x1

Tenure

Leasehold

Allocated parking

Property features

- ✓ No Forward Chain
- ✓ Popular Saltburn Location
- ✓ Spectacular Views of Saltburn's Coastline
- ✓ 2 Double Bedrooms
- ✓ EPC Rating D

Key Information

- ✓ Council Tax: Band A
- ✓ EPC Rating: D
- ✓ Heating supply: Electric

Arrange a viewing

Melanie Devine
Branch Manager
Stockton On Tees

01642 210132
stockton@pattinson.co.uk

- ✓ Flexible viewing slots
- ✓ Accompanied viewings

Description

*****No Froward Chain Top Floor Apartment*****

SOLD VIA ONLINE AUCTION FEES APPLY

Positioned on one of Saltburn's most sought-after roads, this beautiful top floor apartment on Marine Parade offers an exceptional opportunity to enjoy coastal living at its finest. Boasting breath taking views of the Saltburn coastline, this stylish home perfectly blends character, comfort, and an unbeatable location.

As you enter you are greeted by: A Inviting lounge/diner – ideal for relaxing or entertaining, featuring stunning elevated sea views. A well-appointed kitchen – with ample storage and workspace. Two spacious double bedrooms – and a modern family bathroom.

Situated just moments from Saltburn's vibrant town centre, award-winning beach, and iconic attractions, this property offers a lifestyle to match its impressive outlook. Enjoy coastal walks, independent shops, cafés, restaurants, and easy transport links right on your doorstep.

For more information and to arrange an internal inspection please contact the Stockton branch today.

Council Tax Band: A

Tenure: Leasehold

Length of Lease: 120 Years

Annual Service Charge Amount: £660.00

Price: Starting Bid £145,000

Property Type: Apartment

Parking: Allocated

Heating: Electric

Entrance



Hallway

3.56m x 1.46m (11'8" x 4'9")

Lounge

6.01m x 4.54m (19'8" x 14'10")



Dining Area



Kitchen

2.45m x 1.85m (8'0" x 6'0")



Bedroom 1

5.67m x 3.52m (18'7" x 11'6")



Bedroom 2

4.86m x 2.13m (15'11" x 6'11")



Family Bathroom

1.83m x 1.73m (6'0" x 5'8")



Floor Plan



Approx Gross Internal Area
70 sq m / 749 sq ft

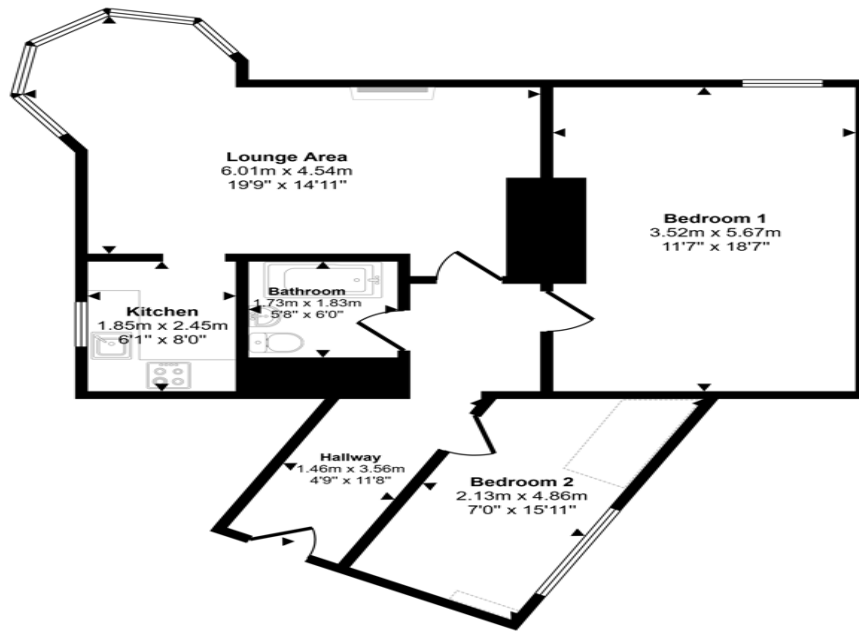

Floorplan

Denotes head height below 1.5m

This floorplan is only for illustrative purposes and is not to scale. Measurements of rooms, doors, windows, and any items are approximate and no responsibility is taken for any error, omission or mis-statement. Icons of items such as bathroom suites are representations only and may not look like the real items. Made with Made Snappy 360.

Energy Efficiency Rating		
	Current	Potential
<i>Very energy efficient - lower running costs</i>		
(92-100) A		
(81-91) B		82
(69-80) C		
(55-68) D	64	
(39-54) E		
(21-38) F		
(1-20) G		
<i>Not energy efficient - higher running costs</i>		
England, Scotland & Wales	EU Directive 2002/91/EC	

Marine Parade, Saltburn, Saltburn-by-the-Sea, North Yorkshire, TS12 1BZ

Contact your local branch today for more information on this property:

20 Bishop Street, Stockton, Cleveland, TS18 1SY, Tel: 01642 210132, stockton@pattinson.co.uk, www.pattinson.co.uk

These particulars, whilst believed to be accurate are set out as a general outline only for guidance and do not constitute any part of an offer or contract. Intending purchasers should not rely on them as statements of representation of fact, but must satisfy themselves by inspection or otherwise as to their accuracy. No person in this firm's employment has the authority to make or give any representation or warranty in respect of the property.

