

To rent

2 bed cottage to rent in TS15

Swinburns Yard, Yarm, Yarm, Durham,
TS15 9AB

£795 pcm

 x2  x1  x1

Allocated parking

Unfurnished

Property features

 EPC Rating C

Key Information

- ✓ Council Tax: Band D
- ✓ EPC Rating: C
- ✓ Heating supply: Gas

Arrange a viewing

Melanie Devine
Branch Manager
Stockton On Tees

01642 210132
stockton@pattinson.co.uk

- ✓ Flexible viewing slots
- ✓ Accompanied viewings

Description

Available to let immediately is this charming two bedroom cottage located just off Yarm's vibrant high street. This property has a unique upside-down living set up, with the large open plan Lounge/Kitchen located on the first floor making the most of the beautiful views over the river Tees, and the two bedrooms and a bathroom located on the ground floor. An allocated parking space is included.

UNFURNISHED

AVAILABLE NOW

EPC RATING C

COUNCIL TAX BAND D

GUARANTOR REQUIRED

Tenant Referencing Criteria:

Pattinson will undertake referencing checks on all applicants over the age of 18 wishing to move into a rental property. As part of this process, we will undertake:

- A credit check to ensure each applicant does not have any adverse credit such as CCJs (County Court Judgements).
- An affordability assessment to ensure applicant's income will sufficiently cover the rental payments.
- To pass the affordability check, each applicant's gross annual basic income (including benefits and pensions) must be at least 30 times the monthly rental amount (36 times for Ellinson properties). EG If the rent is £500 PCM, applicants would need to earn £15,000 as an annual pension or basic salary (excluding commission/bonus) before tax or other deductions were made.

- Each applicant's affordability is assessed individually against the criteria.
- Self-employed applicants will require an accountant's reference and should have accounts for a minimum of two years. Net profit will be assessed against the affordability requirement of 30 times the monthly rental amount.
- Employment checks to confirm your start date, salary and if your position is permanent.
- Homeownership checks (only if you are a homeowner) confirming your mortgage payments are up to date.
- A Landlord reference (if you are currently residing in rented accommodation) confirming you have abided by the terms of the lease. This will check that the rent was paid on time and in full, there was no antisocial behaviour and the property was looked after in an appropriate manner.
- 'Right to rent' ID checks.

If you do not meet the requirement, you WILL REQUIRE A HOMEOWNER GUARANTOR.

Council Tax Band: D

Deposit: £917.00

Length of Tenancy: 6

Rent: £795 pcm

Property Type: Cottage

USPs: Allows children, Allows pets

Parking: Allocated

Heating: Gas

GROUND FLOOR
284 sq.ft. (26.3 sq.m.) approx.

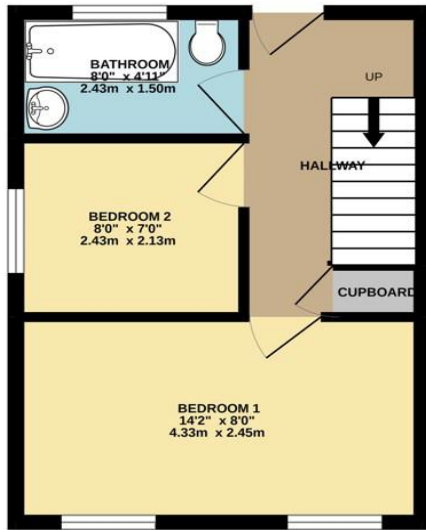

1ST FLOOR
284 sq.ft. (26.3 sq.m.) approx.

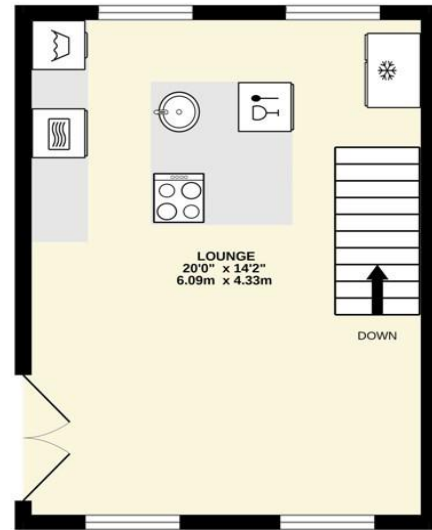

TOTAL FLOOR AREA : 567 sq.ft. (52.7 sq.m.) approx.

Whilst every attempt has been made to ensure the accuracy of the floorplan contained here, measurements of doors, windows, rooms and any other items are approximate and no responsibility is taken for any error, omission or mis-statement. This plan is for illustrative purposes only and should be used as such by any prospective purchaser. The services, systems and appliances shown have not been tested and no guarantee as to their operability or efficiency can be given.
Made with Metropix ©2022

Energy Efficiency Rating		Current	Potential
<i>Very energy efficient - lower running costs</i>			
(92-100) A			
(81-91) B			89
(69-80) C		74	
(55-68) D			
(39-54) E			
(21-38) F			
(1-20) G			
<i>Not energy efficient - higher running costs</i>			
England, Scotland & Wales		EU Directive 2002/91/EC	

Swinburns Yard, Yarm, Yarm, Durham, TS15 9AB

Contact your local branch today for more information on this property:

20 Bishop Street, Stockton, Cleveland, TS18 1SY, Tel: 01642 210132, stockton@pattinson.co.uk, www.pattinson.co.uk

These particulars, whilst believed to be accurate are set out as a general outline only for guidance and do not constitute any part of an offer or contract. Intending purchasers should not rely on them as statements of representation of fact, but must satisfy themselves by inspection or otherwise as to their accuracy. No person in this firm's employment has the authority to make or give any representation or warranty in respect of the property.



RICS

Client Money
Protection

