



To buy

4 bed terraced house to buy in

Upper Howick Street, Alnwick,
Northumberland, NE66 1UZ

£275,000

 x4  x1  x1

Tenure

Freehold

Property features

- ✓ Four Bedroom Townhouse
- ✓ Courtyard Garden
- ✓ Feature Fireplaces
- ✓ No Upward Chain
- ✓ EPC Rating E

On Street parking

Garden

Key Information

- ✓ EPC Rating: E
- ✓ Heating supply: Gas
- ✓ Electric supply: National Grid
- ✓ Water supply: Direct mains water
- ✓ Broadband: FTTP (fibre to the premises)
- ✓ Mobile signal: Good

Arrange a viewing

Darren Tynan
Branch Manager
Alnwick

01665 639110
alnwick@pattinson.co.uk

- ✓ Flexible viewing slots
- ✓ Accompanied viewings

Description

Central location | Mid Terrace Stone Property | Feature Fireplaces | Four bedrooms | Courtyard garden

Pattinson Estate Agents are delighted to welcome to the market this Beautifully presented Character property in Alnwick.

Situated in a Fabulous location, perfectly situated for a stroll into Alnwick town centre.

The property briefly comprises, on the ground floor ; Entrance hallway, giving access to Lounge and kitchen and downstairs WC and stairs leading up to the first floor.

To the first floor ; Landing giving access to the Master bedroom, Bedroom two and family bathroom. Stairs leading up to the Second floor.

To the second floor; Landing giving access to Bedroom three and Four with a Separate WC.

Externally, An enclosed courtyard garden giving an ideal place to sit and relax in a secluded and private area. Plus on street parking to the front.

Ideally located at the heart of the Historic market town of Alnwick, boasting an excellent array of shops, art galleries, tea rooms, pubs and cafes including the well renowned Barter Books. It is also a convenient base for those that enjoy cycling or walking and is just 3 miles from some of Northumberland's' award winning and finest beaches.

Alnwick is also well served by public transport with regular buses running routes to Berwick and Newcastle and with the East Coast mainline trains stopping at nearby Alnmouth Station giving easy access to Edinburgh, Berwick, Newcastle and Kings Cross. Newcastle International Airport is 35 miles to the south.

Viewings Highly Recommended to appreciate this beautifully presented home.

Tenure: Freehold

Price: £275,000

Property Type: Terraced House

USPs: Garden

Parking: On Street

Heating: Gas

Electric: National Grid

Water: Direct mains water

Sewerage: Standard UK domestic

Broadband: FTTP (fibre to the premises)

Mobile signal coverage: Good

Courtyard Garden

Rear gate access | Private and enclosed area



Entrance Hallway

Hallway giving access to Lounge, kitchen and Downstairs WC | Stairs to first floor



Lounge

4.40m x 3.92m (14'5" x 12'10")

Attractive Open Fireplace | Window to front elevation | Central heating radiator



Kitchen

3.77m x 4.09m (12'4" x 13'5")

Inglenook Fireplace | Built in storage cupboard | Large dresser | Stainless steel sink | Electric hob and Oven | Fridge, tumble dryer and washing machine | Cupboard housing boiler | Window to rear elevation | Central heating radiator | Glass door leading out into Courtyard garden



Downstairs WC

Window to rear elevation | WC | Washbasin

First Floor Landing

Landing giving access to stairs to second floor, Master bedroom, Family Bathroom and Bedroom two

Master Bedroom

3.75m x 4.16m (12'3" x 13'7")

Feature Fireplace | Window to rear elevation | Central heating radiator



Bedroom Two

3.75m x 4.00m (12'3" x 13'1")

Feature Fireplace | Window to front elevation | Central heating radiator

Family Bathroom

1.79m x 3.13m (5'10" x 10'3")

Window to front elevation | Bath with shower over | Vanity washbasin
| WC | Central heating radiator



Second Floor Landing

Giving access to Bedroom three and Four and separate WC

Second Floor WC

1.68m x 1.21m (5'6" x 3'11")

Washbasin | WC | Velux window to front elevation | Built in storage cupboard

Bedroom Three

5.67m x 3.90m (18'7" x 12'9")

Velux windows to rear elevation | Central heating radiator



Bedroom Four

3.92m x 2.59m (12'10" x 8'5")

Velux window to front elevation | Central heating radiator | Built in storage

Approx Gross Internal Area
136 sq m / 1468 sq ft

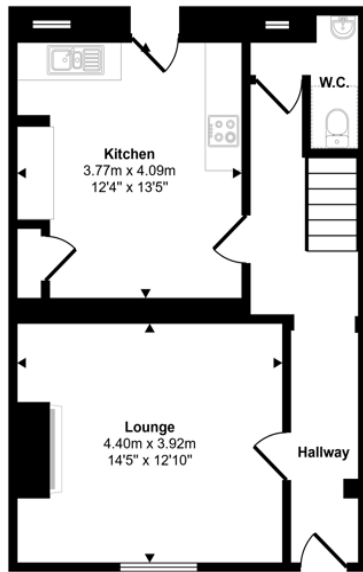

Ground Floor
Approx 48 sq m / 521 sq ft

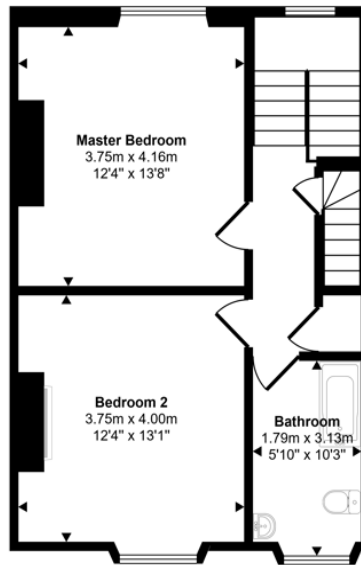

First Floor
Approx 49 sq m / 529 sq ft

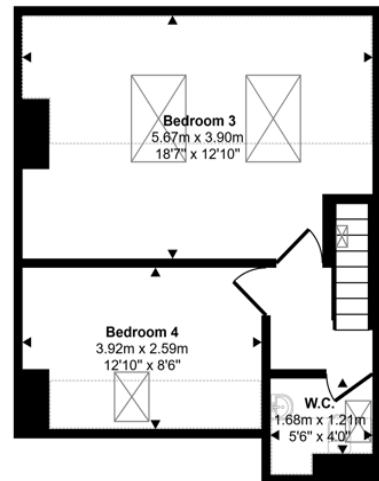

Second Floor
Approx 39 sq m / 418 sq ft

Denotes head height below 1.5m

This floorplan is only for illustrative purposes and is not to scale. Measurements of rooms, doors, windows, and any items are approximate and no responsibility is taken for any error, omission or mis-statement. Icons of items such as bathroom suites are representations only and may not look like the real items. Made with Made Snappy 360.

| Energy Efficiency Rating | | |
|--|-----------|-------------------------|
| | Current | Potential |
| <i>Very energy efficient - lower running costs</i> | | |
| (92-100) A | | |
| (81-91) B | | |
| (69-80) C | | 80 |
| (55-68) D | | |
| (39-54) E | 54 | |
| (21-38) F | | |
| (1-20) G | | |
| <i>Not energy efficient - higher running costs</i> | | |
| England, Scotland & Wales | | EU Directive 2002/91/EC |

Upper Howick Street, Alnwick, Northumberland, NE66 1UZ

Contact your local branch today for more information on this property:

**19 Bondgate Without, Alnwick, Northumberland, NE66 1PY, Tel: 01665 639110,
alnwick@pattinson.co.uk, www.pattinson.co.uk**

These particulars, whilst believed to be accurate are set out as a general outline only for guidance and do not constitute any part of an offer or contract. Intending purchasers should not rely on them as statements of representation of fact, but must satisfy themselves by inspection or otherwise as to their accuracy. No person in this firm's employment has the authority to make or give any representation or warranty in respect of the property.

