



4 bed semi-detached house to buy in NE65

Davison Avenue, Felton, Northumberland, NE65 9NH

£200,000 Offers Over

🏠 x4 🚗 x2 🚻 x1

Tenure
Freehold

Property features

- ✓ Semi Detached House
- ✓ Four Bedrooms
- ✓ Log Burner
- ✓ Large Garden
- ✓ EPC Rating C

Off Street parking

Garden

Key Information

- ✓ Council Tax: Band A
- ✓ EPC Rating: C
- ✓ Heating supply: Gas
- ✓ Electric supply: National Grid
- ✓ Water supply: Direct mains water
- ✓ Mobile signal: Good

Arrange a viewing

Darren Tynan
Branch Manager
Alnwick

01665 639110
alnwick@pattinson.co.uk

- ✓ Flexible viewing slots
- ✓ Accompanied viewings

Description

Semi-Detached House | Four Bedrooms | Desirable Village Location | Spacious Rear Garden | Driveway

Pattinson Estate Agents are delighted to welcome to the market this charming four-bedroom semi-detached house, graciously positioned in the serene and sought-after location of Felton.

The accommodation comprises of four generously proportioned bedrooms. The fourth bedroom is downstairs which makes an ideal guest room with En suite.

To the first floor there are further three bedrooms with a family shower room.

The lounge is very spacious, with a log burner. Ideal for cosy winter evenings. The kitchen/diner is open plan with french doors leading out decking and to the generous sized garden.

Externally, there is a front and large rear garden. With a workshop and shed to the side elevation. There is also driveway parking for a couple of vehicles.

Convenience is at the forefront of this prime location, with local amenities, schools, and public transport links all within close proximity. This is a wonderful opportunity to create a warm and inviting home in a desirable neighbourhood, brimming with potential.

Contact Pattinson Estate Agents to arrange a viewing. Early viewing is highly recommended to appreciate what this home has to offer.

Please contact 01665 639110 or email Alnwick@pattinson.co.uk

Council Tax Band: A

Tenure: Freehold

Price: Offers Over £200,000

Property Type: Semi-detached house

USPs: Garden

Parking: Off Street, Driveway

Year built: 1925

Construction materials: Brick and block

Risk of floods and or erosion: No

Flooded in last 5 years: No

Flood defences: No

Planning permissions or proposals for development: No

Listed property: No

Conservation area: No

Public rights of way: No

Adaptions for accessibility: No

Restrictions: No

Required access: No

Heating: Gas

Electric: National Grid

Water: Direct mains water

Water meter: No

Sewerage: Standard UK domestic

Air conditioning: No

Mobile signal coverage: Good

Front Elevation

Front lawn bordered by low shrubs, plants, and a wooden fence that provides privacy. A driveway with parking for a couple of vehicles.



Entrance Hallway

Stairs to first floor. Under stairs cupboard. Access to downstairs bedroom and lounge.



Downstairs Bedroom Four

Window to side elevation. Access to En suite



Downstairs En Suite

A walk-in style shower featuring a rainfall shower, with a compact white sink with a chrome mixer tap and toilet.



Lounge

A warm and inviting living room centred around an exposed brick fireplace with a wooden mantel and a black wood-burning stove, creating a strong focal point. Large window to the front elevation.



Dining Area

French doors leading out to the rear garden.



Kitchen

A bright, modern kitchen with an L-shaped layout, featuring dark grey shaker-style cabinets with brass knobs and polished grey stone worktops that reflect the strong natural light coming in from two large windows. A gas hob with a stainless-steel extractor hood and matching splashback, giving the space a sleek, contemporary feel. A stainless-steel sink with a curved tap is positioned under the rear elevation window.



Upstairs Landing

Window to front elevation. Access to three bedrooms and Family Shower room.



Master Bedroom

Window to rear elevation overlooking the rear garden. Two built in storage cupboards.



Family Shower Room

Featuring a walk-in style shower enclosed by a clear glass screen, a vanity unit with a curved sink and chrome fittings and toilet. Window to the side elevation.



Bedroom Two

Window to rear elevation over looking the garden.



Bedroom Three

Window to front elevation.



Rear Garden

A spacious rear garden with a large, well-maintained lawn bordered by wooden fencing. A mix of small trees, shrubs, and planting beds line the perimeter.



Rear Elevation

Young trees and shrubs are planted throughout the garden, with a few established trees providing height and structure. Wooden fencing lines both sides, offering privacy and clearly defined boundaries.



Approx Gross Internal Area
86 sq m / 931 sq ft

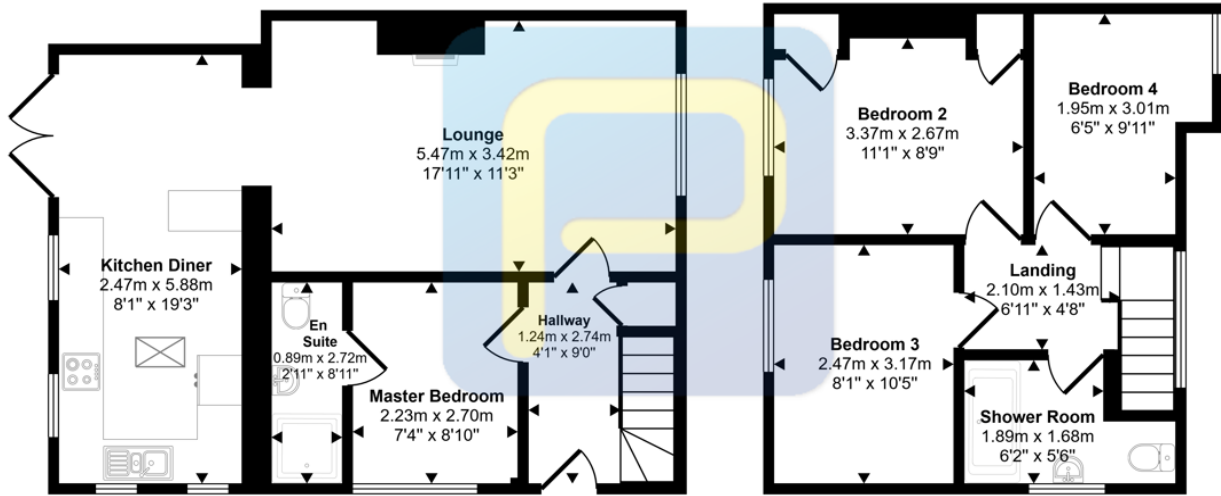

Ground Floor
Approx 51 sq m / 553 sq ft

First Floor
Approx 35 sq m / 378 sq ft

This floorplan is only for illustrative purposes and is not to scale. Measurements of rooms, doors, windows, and any items are approximate and no responsibility is taken for any error, omission or mis-statement. Icons of items such as bathroom suites are representations only and may not look like the real items. Made with Made Snappy 360.

Energy Efficiency Rating		Current	Potential
<i>Very energy efficient - lower running costs</i>			
(92-100) A			
(81-91) B			86
(69-80) C		72	
(55-68) D			
(39-54) E			
(21-38) F			
(1-20) G			
<i>Not energy efficient - higher running costs</i>			
England, Scotland & Wales		EU Directive 2002/91/EC	

Davison Avenue, Felton, Northumberland, NE65 9NH

Contact your local branch today for more information on this property:

**19 Bondgate Without, Alnwick, Northumberland, NE66 1PY, Tel: 01665 639110,
alnwick@pattinson.co.uk, www.pattinson.co.uk**

These particulars, whilst believed to be accurate are set out as a general outline only for guidance and do not constitute any part of an offer or contract. Intending purchasers should not rely on them as statements of representation of fact, but must satisfy themselves by inspection or otherwise as to their accuracy. No person in this firm's employment has the authority to make or give any representation or warranty in respect of the property.

