



**3 bed semi-detached house to buy in SR8**

Neville Road, Peterlee, Durham, SR8 2AG

**£59,000** Starting Bid

 x 3  x 1  x 1

Tenure

**Freehold**

**Property features**

 EPC Rating C

On Street parking

## Key Information

- ✓ Council Tax: Band A
- ✓ EPC Rating: C
- ✓ Heating supply: Gas

## Arrange a viewing

Claire Nasir  
Senior Manager  
Peterlee

0191 5183521  
peterlee@pattinson.co.uk

- ✓ Flexible viewing slots
- ✓ Accompanied viewings

## Description

For sale is this three-bedroom semi-detached in Peterlee. An ideal investment opportunity awaits with this residential property with potential rent of £750pcm.

As you step through the front doorway, there is a hallway leading to the Kitchen and living room and benefiting from extra storage space.

The accommodation encompasses three well-proportioned bedrooms, The rooms are versatile and can be adapted to cater to your individual needs and lifestyle requirements.

The property also features a pleasingly-sized bathroom completed with essential fittings.

The semi-detached features of this residence allow for a private yet spacious dwelling, perfect for any buyer seeking the charms of suburban home life. The property is soundly built, promising a solid investment opportunity for those looking to grow their portfolio.

Situated in the heart of Peterlee, potential buyers can enjoy the best of both worlds with easy access to city amenities while enjoying the comfortable lifestyle offered by living in this inviting neighbourhood.

This property offers an excellent opportunity to both first-time buyers looking for a place to make their own or savvy investors looking for a promising addition to their portfolio.

Don't miss this fantastic opportunity. Contact Pattinson Estate Agents today for more information or to arrange a viewing.

Council Tax Band: A

Tenure: Freehold

Price: Starting Bid £59,000

Property Type: Semi-detached house

Parking: On Street

Heating: Gas

## External



## Kitchen

2.63m x 3.24m (8'7" x 10'7")



## Living Room

6.00m x 3.91m (19'8" x 12'9")



## Bedroom 1

3.32m x 3.90m (10'10" x 12'9")



## Bedroom 2

2.62m x 3.87m (8'7" x 12'8")



## Bedroom 3

2.23m x 2.65m (7'3" x 8'8")



---

## Bathroom



---

## Garden





**Ground Floor**

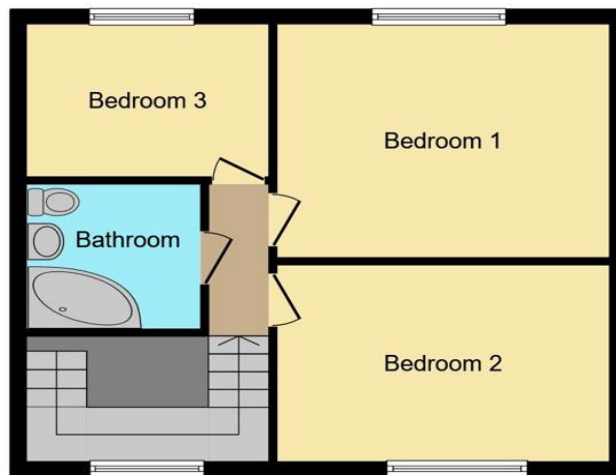

**First Floor**

This plan is for illustration purposes only and may not be representative of the property. Plan not to scale.

Powered by audioagent.com

Energy Efficiency Rating		
	Current	Potential
<i>Very energy efficient - lower running costs</i>		
(92-100) <b>A</b>		
(81-91) <b>B</b>		86
(69-80) <b>C</b>	72	
(55-68) <b>D</b>		
(39-54) <b>E</b>		
(21-38) <b>F</b>		
(1-20) <b>G</b>		
<i>Not energy efficient - higher running costs</i>		
<b>England, Scotland &amp; Wales</b>	EU Directive 2002/91/EC	

Neville Road, Peterlee, Durham, SR8 2AG

Contact your local branch today for more information on this property:

**2 Yoden Way, Peterlee, County Durham, SR8 1BP, Tel: 0191 5183521, peterlee@pattinson.co.uk, www.pattinson.co.uk**

These particulars, whilst believed to be accurate are set out as a general outline only for guidance and do not constitute any part of an offer or contract. Intending purchasers should not rely on them as statements of representation of fact, but must satisfy themselves by inspection or otherwise as to their accuracy. No person in this firms employment has the authority to make or give any representation or warranty in respect of the property.

