



1 bed flat to buy in WD6

Manor Way, Borehamwood,
Hertfordshire, WD6 1BZ

£225,000 Starting Bid

🛏 x1 🚿 x1 🚗 x1

Tenure

Leasehold

Allocated parking

Property features

- ✓ Superb Location
- ✓ High Spec Interior
- ✓ Unrivalled Investment
- ✓ Turn Key apartment
- ✓ EPC Rating B

Key Information

- ✓ Council Tax: Band C
- ✓ EPC Rating: B
- ✓ Heating supply: Electric
- ✓ Electric supply: National Grid
- ✓ Water supply: Direct mains water
- ✓ Broadband: FTTC (fibre to the cabinet)
- ✓ Mobile signal: Good

Arrange a viewing

Vinny Dadhria
Branch Manager
London Auction

0207 867 3382
london@pattinson.co.uk

- ✓ Flexible viewing slots
- ✓ Accompanied viewings

Description

A chance to acquire this superbly presented one double bedroomed apartment in this sought after new development in Borehamwood.

The property is a great investment vehicle for those wanting high calibre tenants and a superb, yield, or first time buyers wishing to get onto the property ladder.

With high specification kitchen and bathroom this is a turn key apartment in the true sense of the word.

Council Tax Band: C

Tenure: Leasehold

Length of Lease: 113

Annual Ground Rent Amount: £299.00

Annual Service Charge Amount: £1,941.00

Price: Starting Bid £225,000

Property Type: Flat

Parking: Allocated

Year built: 2016

Construction materials: Brick and block

Risk of floods and or erosion: No

Flooded in last 5 years: No

Flood defences: No

Planning permissions or proposals for development: No

Coalfield or mining area: No

Listed property: No

Conservation area: No

Public rights of way: No

Adaptions for accessibility: No

Restrictions: No

Required access: No

Heating: Electric

Electric: National Grid

Water: Direct mains water

Water meter: Yes

Sewerage: Standard UK domestic

Air conditioning: No

Broadband: FTTC (fibre to the cabinet)

Mobile signal coverage: Good

Gemini Park Manor WD6

Approx. Gross Internal Area 531 Sq Ft - 49.33 Sq M

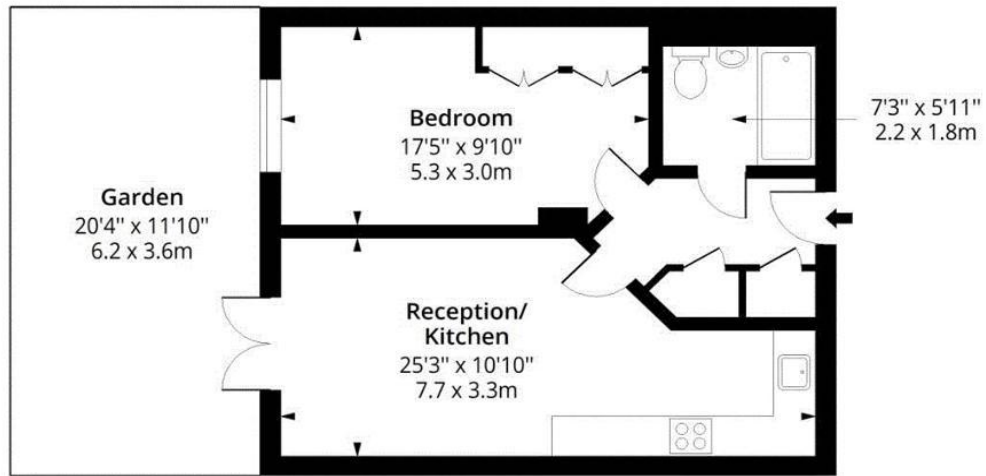
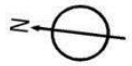

Ground Floor

Floor Area 531 Sq Ft - 49.33 Sq M



Measured according to RICS IPMS2. Floor plan is for illustrative purposes only and is not to scale. Every attempt has been made to ensure the accuracy of the floor plan shown, however all measurements, fixtures, fittings and data shown are an approximate interpretation for illustrative purposes only. 1 sq m = 10.76 sq feet.

lpaplus.com

Date: 18/6/2026

Energy Efficiency Rating		
	Current	Potential
<i>Very energy efficient - lower running costs</i>		
(92-100) A		
(81-91) B	84	84
(69-80) C		
(55-68) D		
(39-54) E		
(21-38) F		
(1-20) G		
<i>Not energy efficient - higher running costs</i>		
England, Scotland & Wales	EU Directive 2002/91/EC	

Manor Way, Borehamwood, Hertfordshire, WD6 1BZ

Contact your local branch today for more information on this property:

**Mercantile House Silverlink, Wallsend, Tyne and Wear, NE28 9NY, Tel: 0207 867 3382,
london@pattinson.co.uk, www.pattinson.co.uk**

These particulars, whilst believed to be accurate are set out as a general outline only for guidance and do not constitute any part of an offer or contract. Intending purchasers should not rely on them as statements of representation of fact, but must satisfy themselves by inspection or otherwise as to their accuracy. No person in this firm's employment has the authority to make or give any representation or warranty in respect of the property.

