



## 4 bed detached house to buy in

Ploverfield Close, Ashington,  
Northumberland, NE63 8LX

# £295,000

 x 4  x 3  x 4

Tenure

**Freehold**

Driveway parking

Garden

## Property features

- ✓ FREEHOLD
- ✓ Detached family home on a generous plot
- ✓ Four bedrooms plus ground floor study/fifth bedroom
- ✓ Spacious lounge open to dining
- ✓ Breakfasting kitchen, utility room and conservatory

## Key Information

- ✓ Council Tax: Band D
- ✓ Heating supply: Gas
- ✓ Electric supply: National Grid
- ✓ Water supply: Direct mains water
- ✓ Broadband: FTTC (fibre to the cabinet)
- ✓ Mobile signal: Good

## Arrange a viewing

Garreth Young  
Branch Manager  
Ashington

01670 568096  
ashington@pattinson.co.uk

- ✓ Flexible viewing slots
- ✓ Accompanied viewings

## Description

Situated on a generous plot within a quiet cul-de-sac on the popular Ploverfield estate in the west end of Ashington, this impressive four/five bedroom detached family home offers spacious and versatile accommodation throughout.

The property is well presented and briefly comprises an entrance hallway, generous lounge opening through to the dining room, breakfasting kitchen, conservatory, utility room, downstairs WC and a study which could also be used as a fifth bedroom. To the first floor are four well-proportioned bedrooms, with the principal bedroom benefiting from an en-suite shower room, along with the family bathroom.

Externally, the property enjoys a large open lawned garden to the front with a driveway providing off-street parking. To the rear is a generous south-facing enclosed garden, offering plenty of space for families and outdoor entertaining.

Ideally located close to the entrance of the estate, the property is within easy reach of local amenities including a family-friendly pub, Co-op convenience store, Ashington train station and the riverside, which offers lovely walks and outdoor space.

Early viewing is highly recommended to fully appreciate the size, layout and location of this excellent family home.

Council Tax Band: D

Tenure: Freehold

Price: £295,000

Property Type: Detached House

USPs: Garden

Parking: Driveway

Year built: 1992

Construction materials: Brick and block

Roofing type: Clay tiles

Risk of floods and or erosion: No

Flooded in last 5 years: No

Flood defences: No

Planning permissions or proposals for development: No

Coalfield or mining area: No

Listed property: No

Conservation area: No

Public rights of way: No

Adaptions for accessibility: No

Restrictions: No

Required access: No

Heating: Gas

Electric: National Grid

Water: Direct mains water

Water meter: No

Sewerage: Standard UK domestic

Air conditioning: No

Broadband: FTTC (fibre to the cabinet)

Mobile signal coverage: Good

## Entrance Porch

UPVC entrance door, herringbone-effect flooring and internal door leading into the hallway.



## Cloaks / WC

Low level WC, pedestal wash hand basin, radiator and UPVC double glazed window.



## Hallway

1.68m x 3.06m (5'6" x 10'0")

Staircase to the first floor landing, radiator, herringbone-effect flooring, understairs storage cupboard and doors leading to the lounge, breakfasting kitchen, utility room, study/bedroom five and cloaks/WC.



## Study - Bedroom 5

2.38m x 2.94m (7'9" x 9'7")

UPVC double glazed window, radiator and fitted carpet. Suitable for use as a study, home office or fifth bedroom.



## Living Room

3.45m x 5.46m (11'3" x 17'10")

UPVC double glazed bay window to the front, two radiators, fitted carpet, television point and open access to the dining room.



## Dining Room

3.50m x 3.11m (11'5" x 10'2")

Radiator, fitted carpet, sliding patio doors to the conservatory and open access to the lounge.



## Conservatory

3.17m x 3.85m (10'4" x 12'7")

UPVC double glazed construction with dwarf wall, radiator, fitted carpet and French doors leading to the rear garden.



## Breakfasting Kitchen

5.67m x 3.13m (18'7" x 10'3")

- 5.67m x 3.13m (18'7" x 10'3")

Fitted with a range of wall and base units with work surfaces incorporating a sink unit. Integrated double oven, gas hob with extractor hood, integrated dishwasher and space for an American-style fridge/freezer. Breakfast bar, tiled splashbacks, radiator, UPVC double glazed window and door leading to the utility room.



## Utility Room

2.08m x 2.11m (6'9" x 6'11")

Fitted base units with work surfaces incorporating a stainless steel sink unit. Plumbing for a washing machine, space for a tumble dryer, radiator, UPVC double glazed window and UPVC door leading to the rear garden.



## First Floor Landing

Loft access, fitted carpet, airing cupboard and doors leading to four bedrooms and the family bathroom.



## Bedroom 1

3.46m x 3.56m (11'4" x 11'8")

UPVC double glazed window, fitted wardrobes, radiator, fitted carpet and door leading to the en-suite shower room.



## En-suite

1.76m x 1.46m (5'9" x 4'9")

Suite comprising shower cubicle, low level WC and wash hand basin. Heated towel radiator, tiled walls, extractor fan and UPVC double glazed window.



## Bedroom 2

2.95m x 3.50m (9'8" x 11'5")

UPVC double glazed window, fitted wardrobes, radiator and fitted carpet.



## Bedroom 3

3.42m x 3.19m (11'2" x 10'5")

UPVC double glazed window, fitted wardrobes, radiator and fitted carpet.



## Bedroom 4

2.48m x 3.21m (8'1" x 10'6")

UPVC double glazed window, fitted wardrobes, radiator and fitted carpet.



## Bathroom

2.31m x 1.67m (7'6" x 5'5")

Suite comprising panelled bath with shower over, vanity wash hand basin and low level WC. Heated towel radiator, tiled walls, extractor fan and UPVC double glazed window.



## Externally

To the front is a generous open lawned garden with a block paved driveway providing off-street parking. Gated side access leads to the rear.

To the rear is a generous south-facing enclosed garden, mainly laid to lawn with a paved patio seating area, raised decking and mature planted borders.



Approx Gross Internal Area  
144 sq m / 1545 sq ft

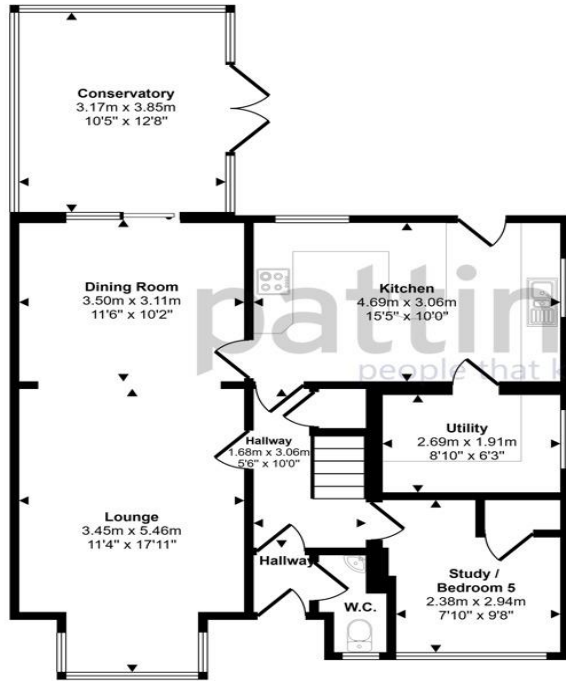

Ground Floor  
Approx 80 sq m / 859 sq ft

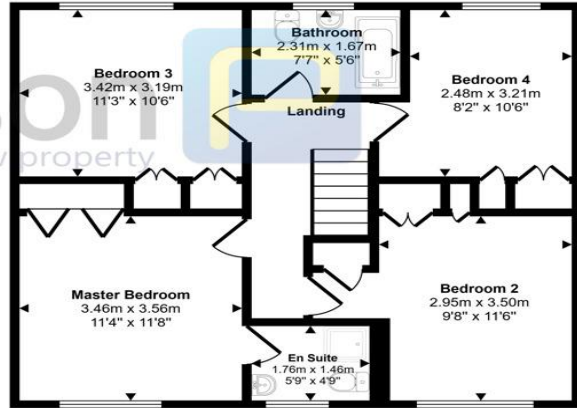

First Floor  
Approx 64 sq m / 685 sq ft

This floorplan is only for illustrative purposes and is not to scale. Measurements of rooms, doors, windows, and any items are approximate and no responsibility is taken for any error, omission or mis-statement. Icons of items such as bathroom suites are representations only and may not look like the real items. Made with Made Snappy 360.

Ploverfield Close, Ashington, Northumberland, NE63 8LX

Contact your local branch today for more information on this property:

**95 Station Road, Ashington, Northumberland, NE63 8RS, Tel: 01670 568096, [ashington@pattinson.co.uk](mailto:ashington@pattinson.co.uk),  
[www.pattinson.co.uk](http://www.pattinson.co.uk)**

These particulars, whilst believed to be accurate are set out as a general outline only for guidance and do not constitute any part of an offer or contract. Intending purchasers should not rely on them as statements of representation of fact, but must satisfy themselves by inspection or otherwise as to their accuracy. No person in this firm's employment has the authority to make or give any representation or warranty in respect of the property.

