



## 2 bed terraced house to buy in

Alderwood, Ashington, Northumberland,  
NE63 8EJ

**£70,000** Starting Bid

🏠 x2 🚿 x1 🚻 x1

Tenure

**Freehold**

Off Street parking

## Property features

- ✓ For Sale By Auction
- ✓ Terraced House
- ✓ Two Bedrooms
- ✓ Ground Floor Cloaks
- ✓ EPC Rating C

## Key Information

- ✓ Council Tax: Band A
- ✓ EPC Rating: C
- ✓ Heating supply: Gas

## Arrange a viewing

Garreth Young  
Branch Manager  
Ashington

01670 568096  
ashington@pattinson.co.uk

- ✓ Flexible viewing slots
- ✓ Accompanied viewings

## Description

\*\*\*FOR SALE BY AUCTION - TERRACED HOUSE - TWO BEDROOMS - WEST END OF ASHINGTON - VIEW NOW\*\*\*

Pattinson Auction offer for sale this two bedroom terraced house situated on Alderwood in the west end of Ashington. A popular location close to local primary and secondary schools and the town centre with an array of shops, supermarkets, leisure facilities and travel links including the new train station linking directly into Newcastle City Centre.

Warmed via gas central heating (combi boiler) and with Upvc double glazing throughout.

Briefly comprising; entrance porch, lounge, inner hallway, kitchen and cloakroom. To the first floor two bedrooms, bathroom and separate w.c. Externally to the rear a block paved garden with outbuilding for storage. There is also a car park to the rear. To the front open plan lawns.

To arrange your viewing please contact our Ashington Team

Council Tax Band: A

Tenure: Freehold

Price: Starting Bid £70,000

Property Type: Terraced House

Parking: Off Street

Heating: Gas

## Entrance Porch

Via main access door to the front. Full length frosted window.



## Lounge

5.05m x 3.96m (16'6" x 12'11")

Window to the front, fireplace and hearth with electric fire, radiator.



## Lounge Additional



## Hallway

Access door to the rear, stairs to first floor, stairlift, understair storage cupboard, radiator.



## Kitchen

3.14m x 2.10m (10'3" x 6'10")

Window to the rear. Fitted with a range of wood effect wall, floor and drawer units with laminate worktops and tiled splashbacks, one and a half sink and drainer with mixer tap, electric cooker point, plumbing for washing machine, radiator.



## Kitchen Additional



## Cloakroom

1.81m x 0.84m (5'11" x 2'9")

Wash hand basin, w.c, radiator.



## First Floor Landing

Window to rear, two built in storage cupboards, one housing the Baxi gas combi boiler.



## Bedroom One

4.05m x 2.84m (13'3" x 9'3")

Window to the front, radiator.



## Bedroom Two

4.04m x 2.12m (13'3" x 6'11")

Window to the front, radiator.



## Bathroom

2.10m x 1.78m (6'10" x 5'10")

Frosted window to the rear. Panelled bath, wash hand basin, tiled walls, radiator.



## W.C

1.82m x 0.87m (5'11" x 2'10")

Frosted window to the rear, w.c, tiled walls, radiator.



## Rear Garden

Secure gate & outbuilding.



## Rear Elevation



## Front Views



Approx Gross Internal Area  
73 sq m / 785 sq ft

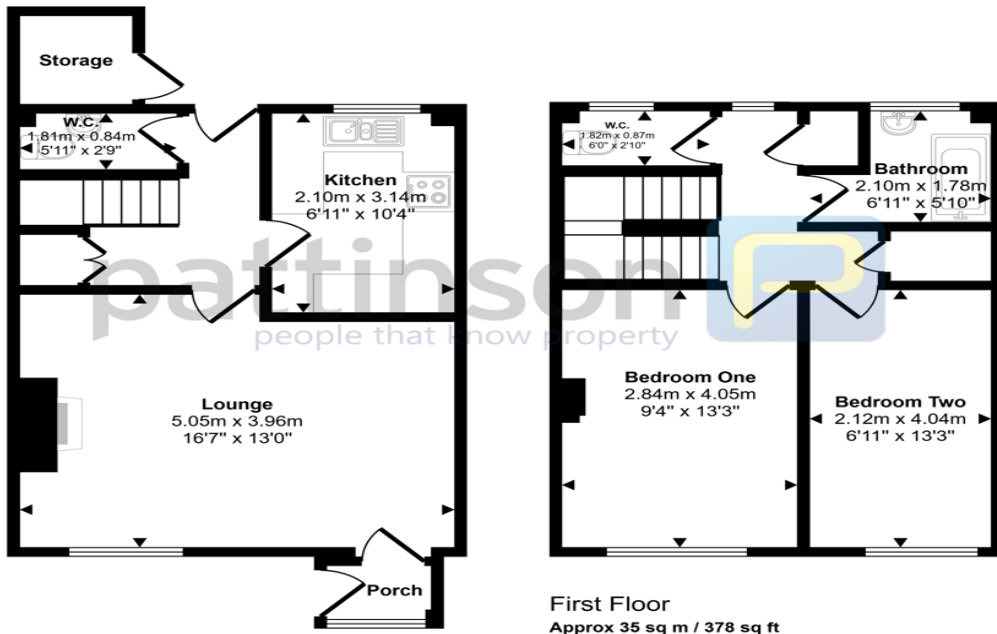

This floorplan is only for illustrative purposes and is not to scale. Measurements of rooms, doors, windows, and any items are approximate and no responsibility is taken for any error, omission or mis-statement. Icons of items such as bathroom suites are representations only and may not look like the real items. Made with Made Snappy 360.

Energy Efficiency Rating		
	Current	Potential
<i>Very energy efficient - lower running costs</i>		
(92-100) <b>A</b>		
(81-91) <b>B</b>		88
(69-80) <b>C</b>	73	
(55-68) <b>D</b>		
(39-54) <b>E</b>		
(21-38) <b>F</b>		
(1-20) <b>G</b>		
<i>Not energy efficient - higher running costs</i>		
<b>England, Scotland &amp; Wales</b>		EU Directive 2002/91/EC

Alderwood, Ashington, Northumberland, NE63 8EJ

Contact your local branch today for more information on this property:

**95 Station Road, Ashington, Northumberland, NE63 8RS, Tel: 01670 568096, [ashington@pattinson.co.uk](mailto:ashington@pattinson.co.uk), [www.pattinson.co.uk](http://www.pattinson.co.uk)**

These particulars, whilst believed to be accurate are set out as a general outline only for guidance and do not constitute any part of an offer or contract. Intending purchasers should not rely on them as statements of representation of fact, but must satisfy themselves by inspection or otherwise as to their accuracy. No person in this firm's employment has the authority to make or give any representation or warranty in respect of the property.

