



3 bed terraced house to buy in

Laburnum Terrace, Ashington,
Northumberland, NE63 0AL

£55,000 Starting Bid

 x3  x1  x1

Tenure

Freehold

On Street parking

Property features

- ✓ For Sale By Auction
- ✓ Terraced House
- ✓ Three Bedrooms
- ✓ In Need Of Refurbishment
- ✓ Available To View Now

Key Information

- ✓ Council Tax: Band A
- ✓ Heating supply: Gas
- ✓ Electric supply: National Grid
- ✓ Water supply: Direct mains water
- ✓ Mobile signal: Good

Arrange a viewing

Garreth Young
Branch Manager
Ashington

01670 568096
ashington@pattinson.co.uk

- ✓ Flexible viewing slots
- ✓ Accompanied viewings

Description

FOR SALE BY AUCTION - TERRACED HOUSE - THREE BEDROOMS - KITCHEN/DINER - UTILITY - UPGRADED SHOWER ROOM - IN NEED OF REFURBISHMENT - IDEAL INVESTMENT - CLOSE TO TOWN CENTRE - AVAILABLE TO VIEW NOW

Pattinson Auction offer for sale this three bedroom terraced house situated on Laburnum Terrace in the heart of Ashington, Northumberland. Ideally located for access to the town centre with an array of shops, supermarkets, leisure facilities and travel links including the new train station which links directly into Newcastle city centre. Local schools are also within walking distance.

In need of refurbishment, this is an ideal investment opportunity. Early viewings are essential to avoid disappointment.

Briefly comprising; entrance hallway, lounge, kitchen/diner and utility. To the first floor three bedrooms and shower room. Externally an enclosed paved town garden to the front. To the rear on street with permit parking.

To arrange your viewing, please contact our Ashington team who will be happy to assist.

Council Tax Band: A

Tenure: Freehold

Price: Starting Bid £55,000

Property Type: Terraced House

Parking: On Street, Permit Parking, Rear

Construction materials: Brick and block

Roofing type: Slate tiles

Heating: Gas

Electric: National Grid

Water: Direct mains water

Sewerage: Standard UK domestic

Mobile signal coverage: Good

Entrance Hallway

Via main access door to the front, stairs to first floor, radiator.



Lounge

4.35m x 4.26m (14'3" x 13'11")

Window to the front, stone fireplace and alcoves, gas fire, radiator.



Lounge Additional



Kitchen/Diner

3.64m x 3.48m (11'11" x 11'5")

Window to the rear. Fitted base units with laminate worktop, stainless steel sink and drainer, electric cooker point, plumbing for washing machine, built in storage cupboards, radiator.



Kitchen/Diner Additional



Utility

Fitted wall, base and drawer units with laminate worktops, wood panelled walls, wood effect flooring.



Storage Room

Frosted window to the rear. Laminate worktops, wood panelled walls, wood effect flooring.



First Floor Landing



Bedroom One

3.66m x 2.78m (12'0" x 9'1")

Window to the rear, three double fitted wardrobes, radiator.



Bedroom Two

4.21m x 2.97m (13'9" x 9'8")

Window to the front, fitted triple wardrobe, radiator.



Bedroom Three

4.12m x 2.36m (13'6" x 7'8")

Window to the front, radiator.
L-shaped.



Shower Room

2.63m x 1.86m (8'7" x 6'1")

Frosted window to the rear. Walk in double shower cubicle with white tray, electric shower and glass screen door, pedestal wash hand basin with chrome taps, push flush w.c, wall mounted mirrored vanity unit, chrome heated towel rail, built in airing cupboard, fully tiled walls and flooring.



Front Garden



Rear Elevation



Approx Gross Internal Area
88 sq m / 945 sq ft

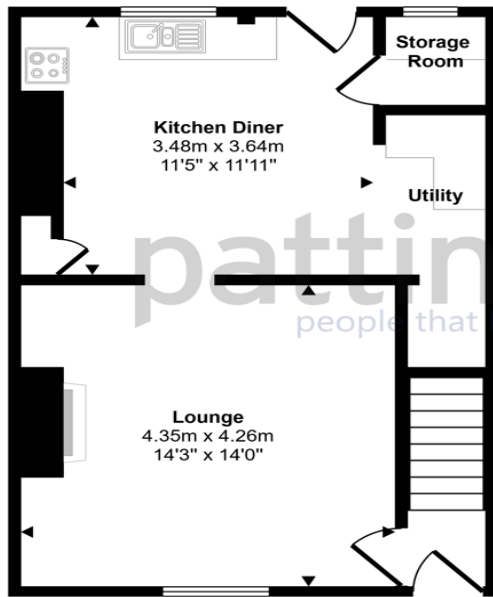

Ground Floor
Approx 44 sq m / 470 sq ft

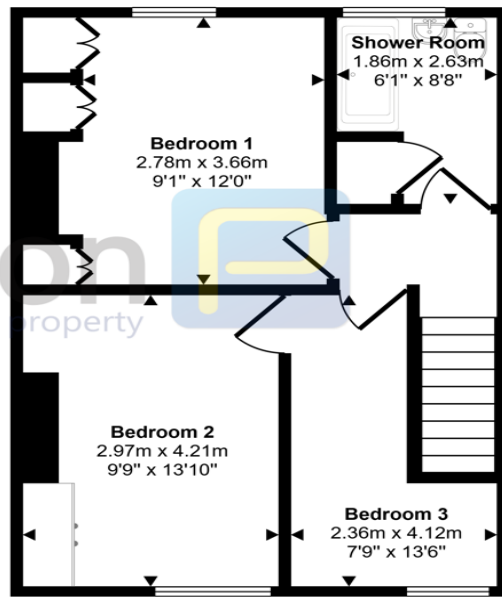

First Floor
Approx 44 sq m / 475 sq ft

This floorplan is only for illustrative purposes and is not to scale. Measurements of rooms, doors, windows, and any items are approximate and no responsibility is taken for any error, omission or mis-statement. Icons of items such as bathroom suites are representations only and may not look like the real items. Made with Made Snappy 360.

Laburnum Terrace, Ashington, Northumberland, NE63 0AL

Contact your local branch today for more information on this property:

**95 Station Road, Ashington, Northumberland, NE63 8RS, Tel: 01670 568096, ashington@pattinson.co.uk,
www.pattinson.co.uk**

These particulars, whilst believed to be accurate are set out as a general outline only for guidance and do not constitute any part of an offer or contract. Intending purchasers should not rely on them as statements of representation of fact, but must satisfy themselves by inspection or otherwise as to their accuracy. No person in this firm's employment has the authority to make or give any representation or warranty in respect of the property.

