



3 bed end of terrace house to buy in NE28

Bathgate Close, Wallsend, Wallsend, Tyne and Wear, NE28 9SU

£85,000 Starting Bid

 x3  x1  x1

Tenure

Freehold

Off Street parking

Property features

- ✓ Three Bedrooms
- ✓ End Of Terrace Property
- ✓ No Upper Chain
- ✓ Close to Local Amenities and Transport Links
- ✓ EPC Rating C

Key Information

- ✓ Council Tax: Band A
- ✓ EPC Rating: C
- ✓ Heating supply: Gas
- ✓ Electric supply: National Grid
- ✓ Water supply: Direct mains water
- ✓ Broadband: ADSL copper wire
- ✓ Mobile signal: Good

Arrange a viewing

Alia Saidan
Branch Manager
Wallsend

0191 2345681
wallsend@pattinson.co.uk

- ✓ Flexible viewing slots
- ✓ Accompanied viewings

Description

For sale via online auction. Fees apply.

Requiring modernisation is this three bedroom end of terrace house which is ideally located close to all local amenities, good schools, and good transport links to Newcastle City Centre, the Coast and South Tyneside.

Comprising; Entrance hall, lounge, dining kitchen to the rear of the property with a good range of wall and base units, complimenting work surfaces, one and a half sink with mixer tap, tiled splashback, space for appliances, space for dining table, UPVC double glazed door out to the rear garden, two UPVC double glazed windows and radiator. To the first floor there are three bedrooms and shower room/WC.

Externally to the front of the property is mainly laid to lawn with brick built shed and fenced boundaries. To the rear is a private garden mainly laid to lawn with paved patio area and fenced boundaries.

AGENTS NOTE: This property is to be sold as seen.

Virtual tour available at link below:

<https://tours.pattinson.co.uk/tour/1ga1g2ec3b>

Please call our Wallsend office on for more information or to book your viewing.

Council Tax Band: A

Tenure: Freehold

Price: Starting Bid £85,000

Property Type: End of terrace house

Parking: Off Street

Construction materials: Brick and block

Roofing type: Clay tiles

Risk of floods and or erosion: No

Flooded in last 5 years: No

Flood defences: No

Planning permissions or proposals for development: No

Coalfield or mining area: No

Listed property: No

Conservation area: No

Public rights of way: No

Adaptions for accessibility: No

Restrictions: No

Required access: No

Heating: Gas

Electric: National Grid

Water: Direct mains water

Water meter: No

Sewerage: Standard UK domestic

Air conditioning: No

Broadband: ADSL copper wire, Cable, FTTC (fibre to the cabinet), FTTP (fibre to the premises)

Mobile signal coverage: Good

Front External

To the front of the property is mainly laid to lawn with brick built shed and fenced boundaries.



Entrance Hall

With doors off to the lounge, dining kitchen, ground floor WC and stairs to the first floor.

Lounge

5.23m x 2.95m (17'1" x 9'8")

UPVC double glazed window to the front and radiator.



Dining Kitchen

5.08m x 3.23m (16'8" x 10'7")

To the rear of the property with a good range of wall and base units, complimenting work surfaces, one and a half sink with mixer tap, tiled splashback, space for appliances, space for dining table, UPVC double glazed door out to the rear garden, two UPVC double glazed windows and radiator.



Ground Floor WC

1.59m x 0.93m (5'2" x 3'0")

With low level WC, hand wash basin, single glazed window and radiator.



First Floor Landing

With doors off to the bedrooms, large storage cupboard and shower room/WC.

Bedroom One

3.43m x 3.09m (11'3" x 10'1")

UPVC double glazed window to the front and radiator.



Bedroom Two

3.72m x 2.64m (12'2" x 8'7")

UPVC double glazed window to the rear, built in wardrobe and radiator.



Bedroom Three

2.77m x 2.33m (9'1" x 7'7")

UPVC double glazed window to the rear and radiator.



Shower Room/WC

2.45m x 1.86m (8'0" x 6'1")

White three piece shower room comprising; walk in shower with glass screen, hand wash basin, low level WC, large storage cupboard, window and radiator.



Rear Garden

Private rear garden mainly laid to lawn with paved patio area and fenced boundaries.



Approx Gross Internal Area
87 sq m / 932 sq ft

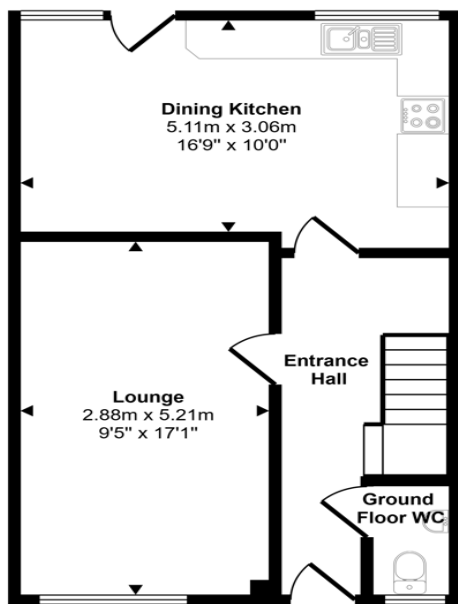

Ground Floor
Approx 43 sq m / 459 sq ft

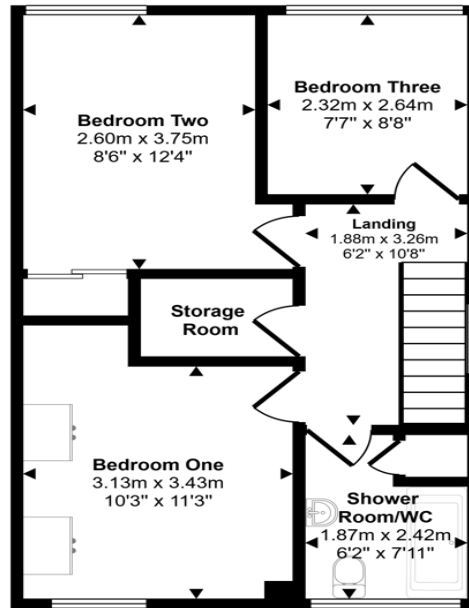

First Floor
Approx 44 sq m / 474 sq ft

This floorplan is only for illustrative purposes and is not to scale. Measurements of rooms, doors, windows, and any items are approximate and no responsibility is taken for any error, omission or mis-statement. Icons of items such as bathroom suites are representations only and may not look like the real items. Made with Made Snappy 360.

| Energy Efficiency Rating | | |
|--|----------------------------|-----------|
| | Current | Potential |
| <i>Very energy efficient - lower running costs</i> | | |
| (92-100) A | | |
| (81-91) B | | |
| (69-80) C | 71 | 79 |
| (55-68) D | | |
| (39-54) E | | |
| (21-38) F | | |
| (1-20) G | | |
| <i>Not energy efficient - higher running costs</i> | | |
| England, Scotland & Wales | EU Directive 2002/91/EC | |

Bathgate Close, Wallsend, Wallsend, Tyne and Wear, NE28 9SU

Contact your local branch today for more information on this property:

**157 High Street East, Wallsend, Newcastle Upon Tyne, Tyne & Wear, NE28 7RL, Tel: 0191 2345681,
wallsend@pattinson.co.uk, www.pattinson.co.uk**

These particulars, whilst believed to be accurate are set out as a general outline only for guidance and do not constitute any part of an offer or contract. Intending purchasers should not rely on them as statements of representation of fact, but must satisfy themselves by inspection or otherwise as to their accuracy. No person in this firm's employment has the authority to make or give any representation or warranty in respect of the property.

