



## 3 bed end of terrace house to buy in DA2

Coombfield Drive, Dartford, Kent, DA2 7LG

**£334,000** Starting Bid

 x 3  x 1  x 2

Tenure

**Freehold**

Driveway & Garage parking

## Property features

- ✓ BEING SOLD VIA SECURE SALE ONLINE BIDDING - T&Cs APPLY
- ✓ Immediate 'exchange of contracts' available
- ✓ Three Bedrooms
- ✓ Kitchen/Diner
- ✓ EPC Rating D

## Key Information

- ✓ Council Tax: Band D
- ✓ EPC Rating: D
- ✓ Heating supply: Gas
- ✓ Electric supply: National Grid
- ✓ Water supply: Direct mains water
- ✓ Broadband: FTTP (fibre to the premises)
- ✓ Mobile signal: Good

## Arrange a viewing

Thomas Jack Smith  
Branch Manager  
South East Auction

01634 565510  
southeast@pattinson.co.uk

- ✓ Flexible viewing slots
- ✓ Accompanied viewings

## Description

\*\*\*Sold via Secure Sale online bidding. Terms & Conditions apply. Starting Bid £300,000\*\*\*

A well-presented three-bedroom semi-detached house offering comfortable family living in a desirable residential setting. The property features a bright and spacious living area, a well-appointed kitchen with ample storage, and three generously sized bedrooms. A modern family bathroom serves the first floor.

Outside, the home benefits from a private rear garden, ideal for relaxing, entertaining, or family activities. To the front, there is convenient off-street parking. The property also includes useful external storage, providing additional space for bikes, tools, or garden equipment.

This attractive home combines practical living space with outdoor amenities, making it ideal for families or professionals alike.

Positioned in a semi-rural village of Darenth and located within 1.5 miles to several highly sought after primary schools such as Fleetdown, Darenth Community, Sutton-At-Hone, Stone St Mary's and Bean as well as The Leigh Academy secondary school. Dartford Crossing, A2 and the M25 are within easy access too.

For sale through Pattinson Auction under Conditional Terms.

Council Tax Band: D

Tenure: Freehold

Price: Starting Bid £334,000

Property Type: End of terrace house

Parking: Driveway & Garage

Construction materials: Brick and block

Roofing type: Clay tiles

Risk of floods and or erosion: No

Flooded in last 5 years: No

Source of flood: Other

Flood defences: No

Planning permissions or proposals for development: No

Coalfield or mining area: No

Listed property: No

Conservation area: No

Public rights of way: No

Adaptions for accessibility: No

Restrictions: No

Required access: No

Heating: Gas

Electric: National Grid

Water: Direct mains water

Water meter: No

Sewerage: Standard UK domestic

Air conditioning: No

Broadband: FTTP (fibre to the premises)

Mobile signal coverage: Good

**Coombfield Drive, Darenth, Dartford, DA2**

Approximate Area = 966 sq ft / 89.7 sq m  
 Outbuilding = 54 sq ft / 5 sq m  
 Total = 1020 sq ft / 94.7 sq m  
 For identification only - Not to scale

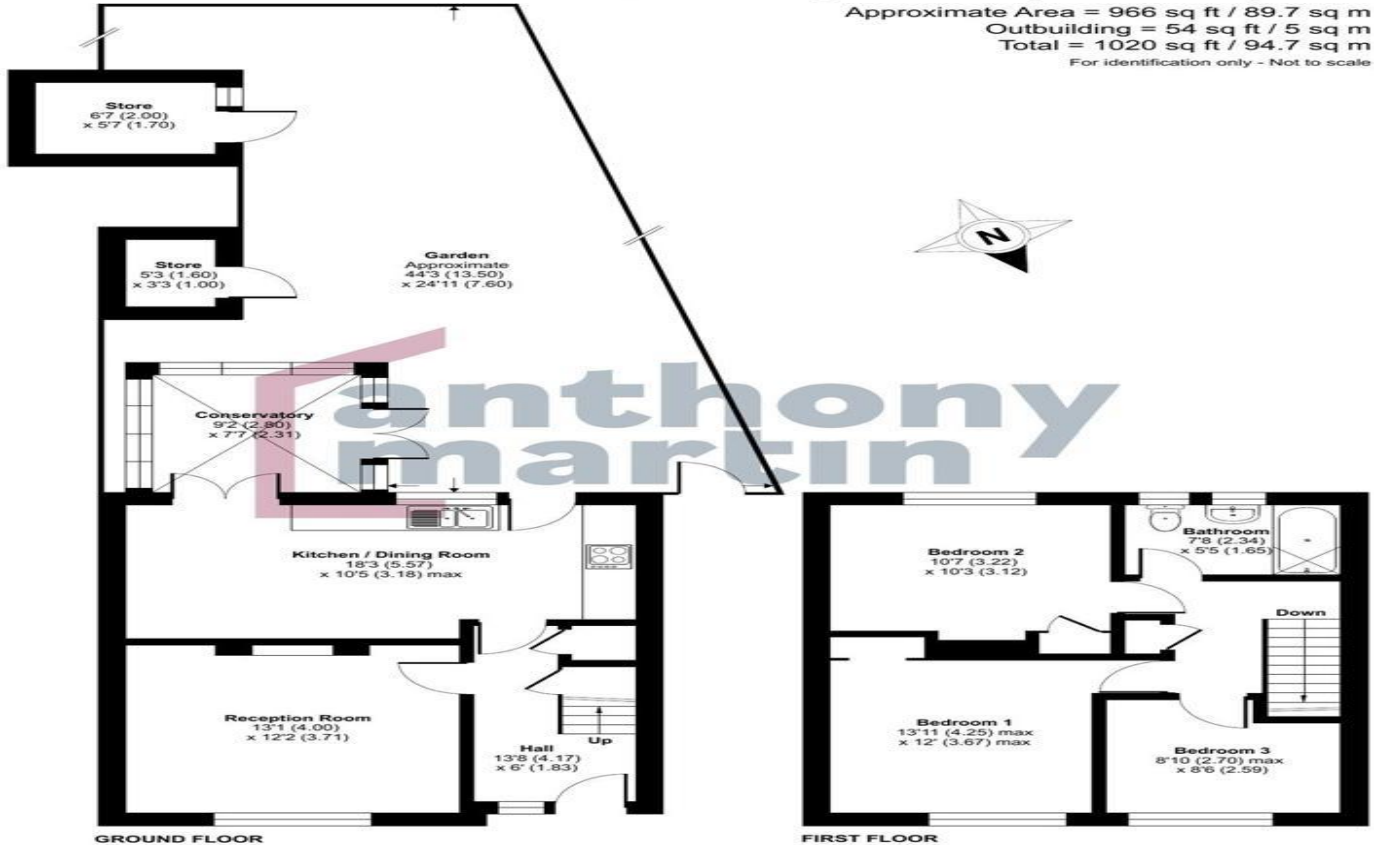

Floor plan produced in accordance with RICS Property Measurement 2nd Edition, Incorporating International Property Measurement Standards (IPMS2 Residential). © nichecom 2026. Produced for Anthony Martin. REF: 1425344

Energy Efficiency Rating		Current	Potential
Very energy efficient - lower running costs			
(92-100) <b>A</b>			
(81-91) <b>B</b>			
(69-80) <b>C</b>			79
(55-68) <b>D</b>	66		
(39-54) <b>E</b>			
(21-38) <b>F</b>			
(1-20) <b>G</b>			
Not energy efficient - higher running costs			
<b>England, Scotland &amp; Wales</b>		EU Directive 2002/91/EC	

Coombfield Drive, Dartford, Kent, DA2 7LG

Contact your local branch today for more information on this property:

**Mercantile House Kingfisher Way, Silverlink Business Park, Wallsend, NE28 9NY, Tel: 01634 565510, southeast@pattinson.co.uk, www.pattinson.co.uk**

These particulars, whilst believed to be accurate are set out as a general outline only for guidance and do not constitute any part of an offer or contract. Intending purchasers should not rely on them as statements of representation of fact, but must satisfy themselves by inspection or otherwise as to their accuracy. No person in this firms employment has the authority to make or give any representation or warranty in respect of the property.

