

ELEVATIONS PROPOSED

SCALE: 1:50@A1

CONTRACTORS MUST CHECK ALL DIMENSIONS
 CHECK WORK FROM SQUARE DIMENSIONS
 DIMENSIONS MUST BE REPORTED IMMEDIATELY TO THE ARCHITECT
 TO AVOID INSTRUCTIONS BEING REISSUED
IF IN DOUBT - ASK

DATE	REVISION
22.03.24	A REVISION FOOTPRINT, SCALE AND FINISHES REDUCED SIGNIFICANTLY AND PULLED AWAY FROM EXISTING CONCRETE TO PREVIOUSLY UNDEVELOPED APPLICATION FOR ERECTION WITH MATERIAL CHANGES TO MATCH EXISTENCE

PROPOSED FINISHES

EXTERNAL WALLS:
 NATURAL LOCAL STONEMWORK FINISH -
 COLOUR - BROWN/BEGE TO MATCH
 SURROUNDINGS WITH RED BRICK
 QUOINING.

ROOF FINISHES:
 FIRST SELECTION NATURAL SLATE -
 COLOUR - BLUE/GRY

WINDOWS:
 POWDERCOATED ALUMINIUM -
 COLOUR - WHITE

DOORS:
 POWDERCOATED ALUMINIUM -
 COLOUR - GREY

RAINFWATER COODS:
 POWDERCOATED ALUMINIUM -
 COLOUR - BLACK

BILLY LEWIS ARCHITECTS
 No.1 Victoria Road, Malpas Road, Truro, Cornwall, TR1 1GH
 01872 212122 | billy.lewis@billylewis.co.uk
 www.billylewis.co.uk

CLIENT	M.R. WEDDEN
PROJECT	NEW BUILDING TO GARDEN OF TREVENKER LODGE, NEWQUAY, TR8
DRAWING	PLANNING SERIES ELEVATIONS AS PROPOSED
SCALE	1:50 @A1
DRAWN	BS
DIRECTOR	JM
CHECKED	BS
DATE	22.03.24
PLANNING	
23021.3.006 A	

SCALE IN METRES 1:50 @ A1

Land & Development in TR8

Trevemper, Trevemper, Newquay,
 Cornwall, TR8 4QD

£70,000 Starting Bid

Tenure
Freehold

Residents parking

Property features

- ✓ Planning GRANTED - PA24/02470
- ✓ Priced to Sell
- ✓ Immediate 'exchange of contracts' available

Arrange a viewing

Lisa Neil
Branch Manager
Commercial National

0191 737 1154
commercial@pattinson.co.uk

- ✓ Flexible viewing slots
- ✓ Accompanied viewings

Description

For sale via secure sale online bidding - terms and conditions apply.

We are delighted to bring to the market the opportunity to acquire this plot with planning permission granted for a two bedroom detached cottage, planning reference number PA24/02470.

This is a fantastic opportunity for the next purchaser and we encourage registering your interest early to avoid disappointment.

Please note the entrance is shared access and parking is designated to the allocated spaces.

Please note we have not inspected this property.

Price: Starting Bid £70,000

Property Type: Land & Development

Business Type: Residential Investments

Parking: Residents

Location

The plot is located in Trevemper, on the southern outskirts of Newquay, just 1.5 miles from the town centre.

Site details

Planning permission granted for a new dwelling, two bedroom detached cottage.

Tenure

Freehold, subject to title split.

Additional Information

For further information please contact our office directly on 0191 737 1154, or alternatively via email on commercial@pattinson.co.uk. With regards to viewing subject property, this is to be done strictly by appointment.

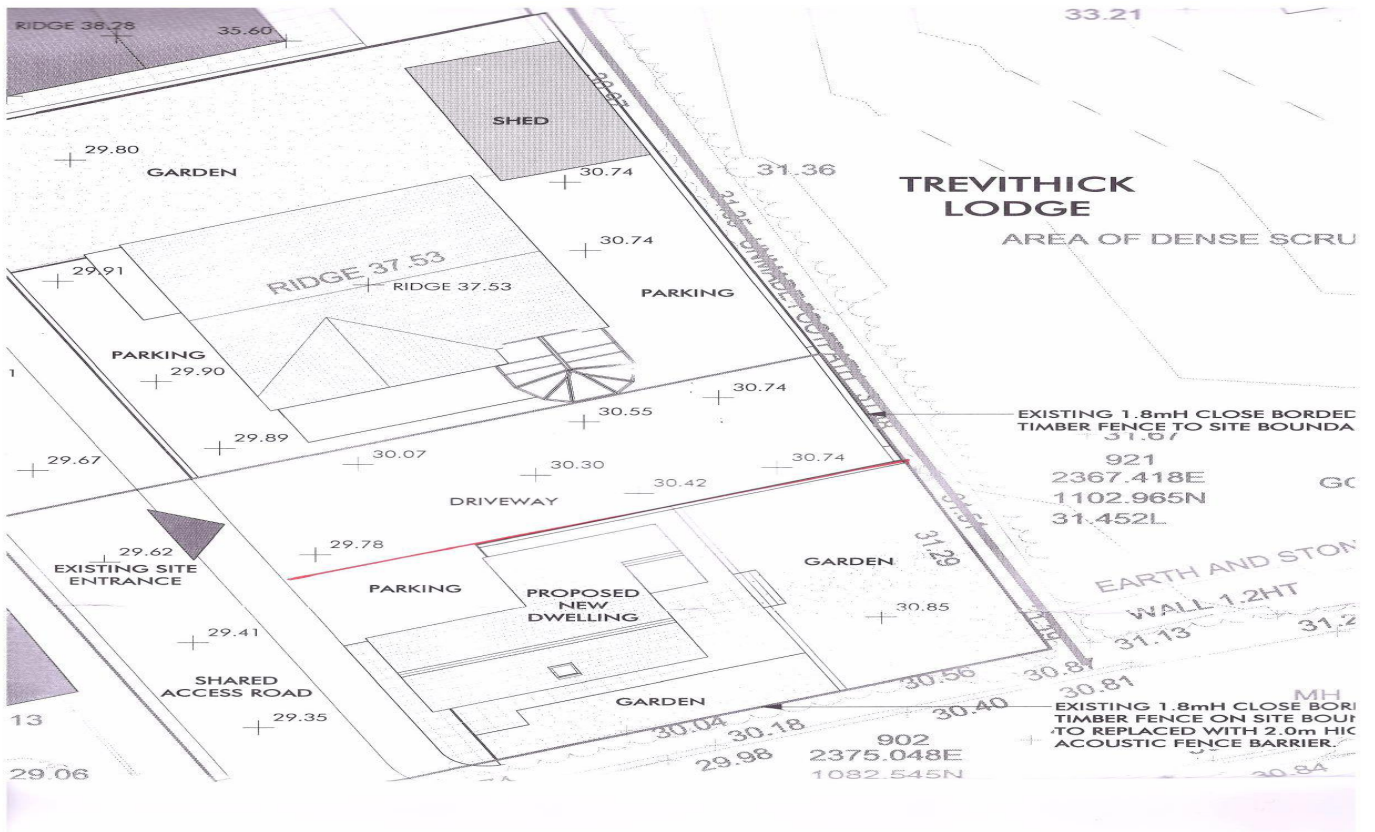

Trevemper, Trevemper, Newquay, Cornwall, TR8 4QD

Contact your local branch today for more information on this property:

**Keith Pattinson Silverlink, Wallsend, Tyne and Wear, NE28 9NY, Tel: 0191 737 1154 ,
commercial@pattinson.co.uk, www.pattinson.co.uk**

These particulars, whilst believed to be accurate are set out as a general outline only for guidance and do not constitute any part of an offer or contract. Intending purchasers should not rely on them as statements of representation of fact, but must satisfy themselves by inspection or otherwise as to their accuracy. No person in this firm's employment has the authority to make or give any representation or warranty in respect of the property.

