



### 3 bed terraced house to buy in

Cavendish Gardens, Ashington, Ashington,  
Northumberland, NE63 0EW

**£50,000** Starting Bid

 x3  x1  x1

Tenure

**Freehold**

### Property features

- ✓ Three Bedrooms
- ✓ Terrace House
- ✓ D/G & GCH
- ✓ Requires Updating
- ✓ Garden to front, Yard to rear

Allocated parking

## Key Information

- ✓ Council Tax: Band A
- ✓ Heating supply: Gas
- ✓ Electric supply: National Grid
- ✓ Water supply: Direct mains water

## Arrange a viewing

Garreth Young  
Branch Manager  
Ashington

01670 568096  
ashington@pattinson.co.uk

- ✓ Flexible viewing slots
- ✓ Accompanied viewings

## Description

TO BE SOLD via ONLINE AUCTION. Fees apply.

\*\*\* MID TERRACED HOUSE \*\*\* REQUIRES UPDATING\*\*\* THREE BEDROOM \*\*\* GARDEN & YARD\*\*\*

Offered to the market for sale this three bedroom mid terrace property located on Cavendish Gardens on Ashington.

Located close to the town centre and all amenities including shops, schools and transport links with easy access to the A189 spine road.

Accommodation briefly comprises:- lounge, kitchen, bathroom, to the first floor there are three bedrooms. Externally there is a small yard to the rear with outhouses and garden to the front.

EPC:TBC

Council Tax Band: A

Tenure: Freehold

Price: Starting Bid £50,000

Property Type: Terraced House

USPs: Requires work

Parking: Allocated

Heating: Gas

Electric: National Grid

Water: Direct mains water

Sewerage: Standard UK domestic

## Entrance Hallway

Via double glazed door  
-Stairs to first floor



## Living Room

3.55m x 4.397.00m (11'7" x 14'4.25'10")

Double glazed window to front  
-Radiator  
-Under stairs cupboard  
-Storage cupboard



## Additional Image



## Kitchen

4.47m x 2.08m (14'7" x 6'9")

Double glazed window and door to rear  
-Fitted base units with work tops  
-Plumbed for washing machine  
-Cooker point  
-Part tiled walls  
-Radiator



## Additional Image 1



## Additional Image 2



## Bathroom

- Double glazed window
- Panelled bath
- Low level wc
- Pedestal wash hand basin
- Tiled walls



## Bedroom 1

4.52m x 3.15m (14'9" x 10'4")

- 2 x double glazed windows to front
- Radiator



## Bedroom 2

2.20m x 3.39m (7'2" x 11'1")

- Double glazed window
- Radiator



## Bedroom 3

2.13m x 2.21m (6'11" x 7'3")

- Double glazed window
- Radiator



## Rear External

Enclosed rear yard with outhouses



---

## Front Garden

Mainly laid to lawn with mature hedges



Approx Gross Internal Area  
64 sq m / 687 sq ft

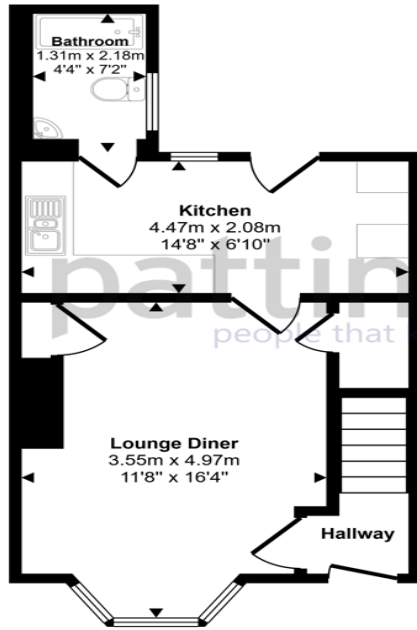

Ground Floor  
Approx 34 sq m / 362 sq ft

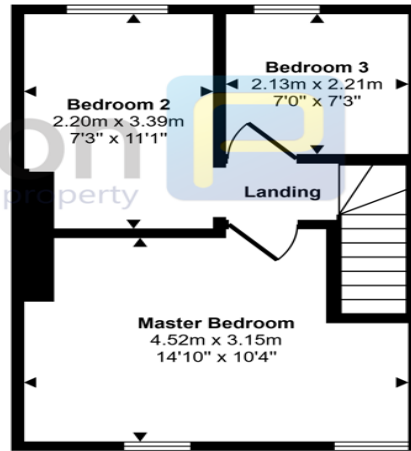

First Floor  
Approx 30 sq m / 325 sq ft

This floorplan is only for illustrative purposes and is not to scale. Measurements of rooms, doors, windows, and any items are approximate and no responsibility is taken for any error, omission or mis-statement. Icons of items such as bathroom suites are representations only and may not look like the real items. Made with Made Snappy 360.

Cavendish Gardens, Ashington, Ashington, Northumberland, NE63 0EW

Contact your local branch today for more information on this property:

**95 Station Road, Ashington, Northumberland, NE63 8RS, Tel: 01670 568096, [ashington@pattinson.co.uk](mailto:ashington@pattinson.co.uk), [www.pattinson.co.uk](http://www.pattinson.co.uk)**

These particulars, whilst believed to be accurate are set out as a general outline only for guidance and do not constitute any part of an offer or contract. Intending purchasers should not rely on them as statements of representation of fact, but must satisfy themselves by inspection or otherwise as to their accuracy. No person in this firm's employment has the authority to make or give any representation or warranty in respect of the property.

