



3 bed semi-detached house to buy in NE35

Shelley Avenue, Boldon Colliery, Tyne and Wear, NE35 9EA

£129,950

 x 3  x 1  x 2

Tenure

Freehold

Driveway parking

Property features

- ✓ THREE BEDROOM SEMI-DETACHED
- ✓ TWO RECEPTION ROOMS
- ✓ LARGE REAR GARDEN
- ✓ MODERN FITTED KITCHEN & BATHROOM
- ✓ EPC Rating D

Key Information

- ✓ Council Tax: Band A
- ✓ EPC Rating: D
- ✓ Heating supply: Gas
- ✓ Electric supply: National Grid
- ✓ Water supply: Direct mains water
- ✓ Broadband: ADSL copper wire
- ✓ Mobile signal: Good

Arrange a viewing

Jason Olley
Branch Manager
Jarrow

0191 4897431
jarrow@pattinson.co.uk

- ✓ Flexible viewing slots
- ✓ Accompanied viewings

Description

Pattinson Estate Agents welcome to the market this Three Bedroom Semi-Detached located on Shelley Avenue, Boldon Colliery.

SOLD WITH NO UPPER CHAIN!

Spacious throughout, this ideal starter home has been upgraded throughout and benefits from two reception rooms, kitchen with utility & ground floor cloak.

The property is ideally located for local amenities with ASDA Walmart just a short journey away with public transport available to Newcastle City Centre, South Shields & Sunderland City Centre.

Briefly comprises; Entrance/Hall, Lounge, Dining Room, Kitchen, Utility, Cloak & to the first floor lies Three Bedrooms & the Family Bathroom. Externally to the front is a stone driveway leading to the Entrance and to the rear a large private Garden with lawn & patio.

Call Pattinson Jarrow on 0191 4897431 or email jarrow@pattinson.co.uk

Council Tax Band: A

Tenure: Freehold

Price: Offers In The Region Of £129,950

Property Type: Semi-detached house

Parking: Driveway

Heating: Gas

Electric: National Grid

Water: Direct mains water

Water meter: No

Sewerage: Standard UK domestic

Air conditioning: No

Broadband: ADSL copper wire

Mobile signal coverage: Good

External Front

Decorative stone patio & pathway leading to Entrance, gated access to rear aspect;



Entrance/Hallway

UPVC part glazed door leading to Entrance, stairs to first floor, gas central heating radiator, built in storage;

Lounge

4.06m x 3.81m (13'3" x 12'6")

Double glazed window to front aspect, gas central heating radiator;



Dining Room

2.49m x 2.99m (8'2" x 9'9")

Gas central heating radiator, French doors leading to Garden;



Kitchen

3.03m x 2.47m (9'11" x 8'1")

A range of wall and base units with contrasting work surfaces, stainless steel sink with mixer tap over, integrated electric oven, electric hob with extractor over, breakfast bar, tiled splashbacks, plumbing for dishwasher, space for fridge freezer, vinyl flooring, double glazed window to rear aspect, gas central heating radiator;



Utility

2.38m x 1.06m (7'9" x 3'5")

Door to cloak, gas central heating radiator, plumbing for washing machine, UPVC part glazed door to Garden;

Cloak

0.78m x 1.07m (2'6" x 3'6")

W/C with combination wash hand basin, laminate flooring, single glazed window to side aspect;

First Floor Landing

2.06m x 1.62m (6'9" x 5'3")

Loft access, double glazed window to side aspect;



Bedroom One

4.05m x 3.58m (13'3" x 11'8")

Double glazed window to front aspect, gas central heating radiator, built in storage;



Bedroom Two

4.02m x 2.52m (13'2" x 8'3")

Double glazed window to rear aspect, gas central heating radiator, built in storage;



Bedroom Three

Double glazed window to front aspect, gas central heating radiator;



Family Bathroom

2.04m x 1.71m (6'8" x 5'7")

A white suite consisting of bath with handheld shower over, pedestal wash hand basin, W/C, tiled walls, gas central heating radiator, tiled flooring, double glazed window to rear aspect;



External Rear

Private enclosed Garden with lawn, paved patio, decorative flowerbeds, external storage, eternal water source, external lighting, gated access to front aspect;



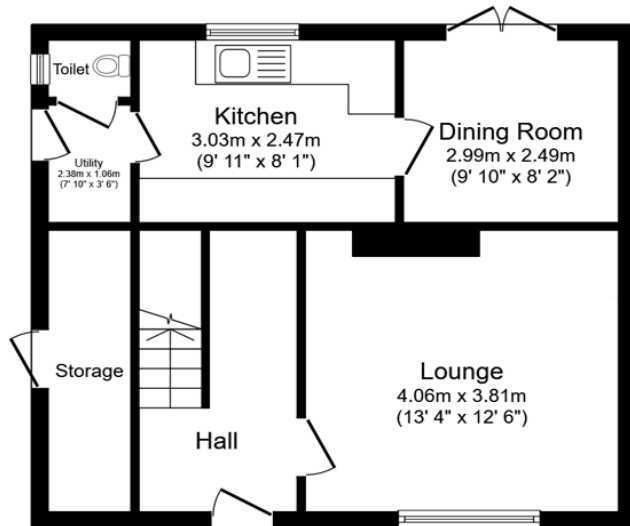

Ground Floor
Floor area 46.5 sq.m. (500 sq.ft.)

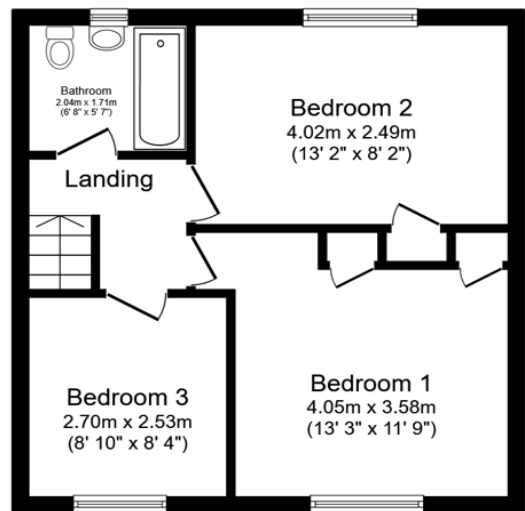

First Floor
Floor area 39.1 sq.m. (420 sq.ft.)

Total floor area: 85.5 sq.m. (921 sq.ft.)

This floor plan is for illustrative purposes only. It is not drawn to scale. Any measurements, floor areas (including any total floor area), openings and orientations are approximate. No details are guaranteed, they cannot be relied upon for any purpose and do not form any part of any agreement. No liability is taken for any error, omission or misstatement. A party must rely upon its own inspection(s). Powered by www.Propertybox.io

| Energy Efficiency Rating | | |
|--|---------|-------------------------|
| | Current | Potential |
| <i>Very energy efficient - lower running costs</i> | | |
| (92-100) A | | |
| (81-91) B | | |
| (69-80) C | | 73 |
| (55-68) D | 64 | |
| (39-54) E | | |
| (21-38) F | | |
| (1-20) G | | |
| <i>Not energy efficient - higher running costs</i> | | |
| England, Scotland & Wales | | EU Directive 2002/91/EC |

Shelley Avenue, Boldon Colliery, Tyne and Wear, NE35 9EA

Contact your local branch today for more information on this property:

67 Ellison Street, Jarrow, South Tyneside, Tyne & Wear, NE32 3JU, Tel: 0191 4897431, jarrow@pattinson.co.uk, www.pattinson.co.uk

These particulars, whilst believed to be accurate are set out as a general outline only for guidance and do not constitute any part of an offer or contract. Intending purchasers should not rely on them as statements of representation of fact, but must satisfy themselves by inspection or otherwise as to their accuracy. No person in this firm's employment has the authority to make or give any representation or warranty in respect of the property.

