



3 bed upper flat to buy in NE3

Salters Road, Gosforth, Newcastle upon Tyne, Tyne and Wear, NE3 4XJ

£190,000 Offers Over

 x3  x1  x1

Tenure

Leasehold

Property features

- ✓ Council Tax Band A
- ✓ EPC C
- ✓ Vacant Possession
- ✓ Central Location
- ✓ EPC Rating C

On Street parking

Key Information

- ✓ Council Tax: Band A
- ✓ EPC Rating: C
- ✓ Heating supply: Gas
- ✓ Electric supply: National Grid
- ✓ Water supply: Direct mains water
- ✓ Broadband: Cable
- ✓ Mobile signal: Good

Arrange a viewing

Maurice Porteous
Branch Manager
Gosforth

0191 2303365
gosforth@pattinson.co.uk

- ✓ Flexible viewing slots
- ✓ Accompanied viewings

Description

Pattinson Gosforth are pleased to introduce a delightful Upper Flat located in the prestigious area of Gosforth, Newcastle upon Tyne, near to the highly desirable Ashburton Village, this spacious property, is offered for Residential Sale. This property is pleasantly tucked away in one of Gosforth's most desired locales.

This charming property presents three well-proportioned bedrooms, offering plentiful space for development and personalisation. Each room is filled with an abundance of natural light, streaming in from large well-positioned windows that also offer a view of the lovely neighbourhood.

In addition to the bedrooms, the property boasts one generous reception room, which makes for a great entertainment space or relaxing lounge area. Furthermore, there's a single bathroom housing essential amenities, and a well-proportioned galley style kitchen, with plenty of wall and base units.

One of the major advantages of this flat is that it comes with Vacant Possession, meaning you can move in at your earliest convenience without the stress of arranging removal dates around existing tenants.

For administrative matters, Council Tax is set at Band A, making this an affordable choice when considering additional housing costs. Complete with an EPC rating of C, indicating a reasonably good efficiency level.

Overall, this superb upper flat presents a fantastic opportunity for those seeking a comfortable and stylish abode in Gosforth, Newcastle upon Tyne. Be sure not to miss out on this amazing property, get in touch with Pattinson Estate Agents for more information or to arrange a viewing.

Council Tax Band: A

Tenure: Leasehold

Length of Lease: 993

Ground Rent Review Period: peppercorn

Price: Offers Over £190,000

Property Type: Upper Flat

Parking: On Street

Construction materials: Brick and block

Roofing type: Slate tiles

Risk of floods and or erosion: No

Flooded in last 5 years: No

Flood defences: No

Planning permissions or proposals for development: No

Coalfield or mining area: No

Listed property: No

Conservation area: No

Public rights of way: No

Adaptions for accessibility: No

Restrictions: No

Required access: No

Heating: Gas

Electric: National Grid

Water: Direct mains water

Water meter: No

Sewerage: Standard UK domestic

Air conditioning: No

Broadband: Cable, FTTP (fibre to the premises)

Mobile signal coverage: Good

External



Kitchen

2.16m x 3.06m (7'1" x 10'0")



Living Room

3.81m x 4.51m (12'6" x 14'9")



Bedroom 1

3.82m x 4.85m (12'6" x 15'10")



Bedroom 2

2.32m x 3.30m (7'7" x 10'9")



Bedroom 3

2.32m x 2.58m (7'7" x 8'5")



Bathroom

1.93m x 2.99m (6'3" x 9'9")



Approx Gross Internal Area
73 sq m / 782 sq ft

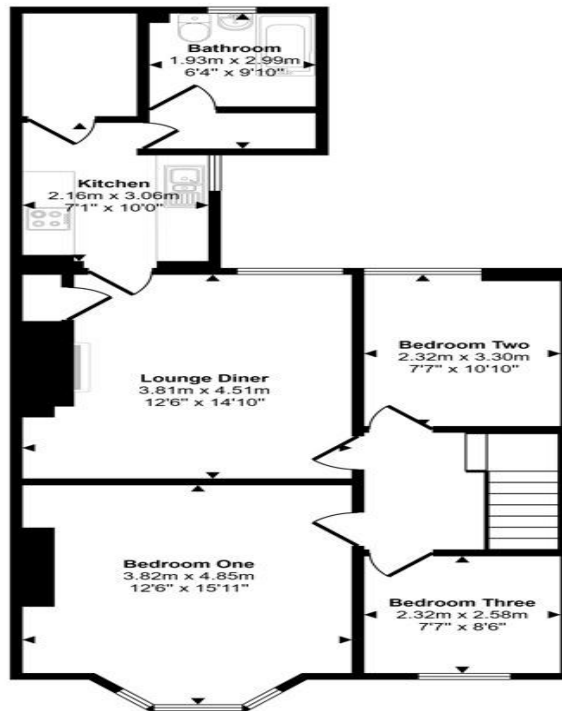

First Floor

This floorplan is only for illustrative purposes and is not to scale. Measurements of rooms, doors, windows, and any items are approximate and no responsibility is taken for any error, omission or mis-statement. Icons of items such as bathroom suites are representations only and may not look like the real items. Made with Made Snappy 360.

Energy Efficiency Rating		
	Current	Potential
<i>Very energy efficient - lower running costs</i>		
(92-100) A		
(81-91) B		
(69-80) C	71	77
(55-68) D		
(39-54) E		
(21-38) F		
(1-20) G		
<i>Not energy efficient - higher running costs</i>		
England, Scotland & Wales	EU Directive 2002/91/EC	

Salters Road, Gosforth, Newcastle upon Tyne, Tyne and Wear, NE3 4XJ

Contact your local branch today for more information on this property:

**210 High Street, Gosforth, Newcastle Upon Tyne, Tyne & Wear, NE3 1HH, Tel: 0191 2303365,
gosforth@pattinson.co.uk, www.pattinson.co.uk**

These particulars, whilst believed to be accurate are set out as a general outline only for guidance and do not constitute any part of an offer or contract. Intending purchasers should not rely on them as statements of representation of fact, but must satisfy themselves by inspection or otherwise as to their accuracy. No person in this firm's employment has the authority to make or give any representation or warranty in respect of the property.

